

LAGRANGE COUNTY LOCAL EMERGENCY PLANNING COMMITTEE



HAZARDOUS MATERIALS EMERGENCY RESPONSE PLAN

January 2022

LAGRANGE COUNTY HAZARDOUS MATERIALS
EMERGENCY RESPONSE PLAN

TABLE OF CONTENTS

| | | |
|-------|--|----|
| I. | INTRODUCTION..... | 4 |
| | A. Scope of Hazardous Materials Response | 4 |
| | B. Purpose | 4 |
| | C. Situations and Assumptions | 5 |
| | D. Concept of Operations | 8 |
| | E. Organization, Responsibilities, and Assignment of Tasks | 9 |
| | F. Relationships to Other Plans | 15 |
| II. | RESPONSE FUNCTIONS..... | 15 |
| | A. Emergency Response Notification Summary | 15 |
| | B. Public Protection Options | 17 |
| | C. Direction and Control | 17 |
| | D. Communications between Responders..... | 19 |
| | E. Response Personnel Safety | 19 |
| | F. Fire and Rescue | 20 |
| | G. Law Enforcement | 21 |
| | H. Emergency Medical Services | 22 |
| | I. On-Going Incident Assessment | 22 |
| | J. Warning and Emergency Notification | 22 |
| | K. Public Information | 22 |
| | L. Personal Protection & Evacuation of Citizens..... | 23 |
| | M. Human Services | 24 |
| | N. Health and Medical Services | 24 |
| | O. Public Works | 25 |
| | P. Resource Management | 25 |
| III. | CONTAINMENT AND RESTORATION..... | 25 |
| | A. Resources | 25 |
| | B. Restoration | 26 |
| IV. | DOCUMENTATION AND INVESTIGATIVE FOLLOW UP | 26 |
| | A. Level I HazMat Incident | 26 |
| | B. Level II and Level III HazMat Incidents | 26 |
| V. | TRAINING AND EXERCISES..... | 27 |
| | A. Training | 27 |
| | B. Exercises | 28 |
| VI. | ANNEX MAINTENANCE..... | 28 |
| VII. | AUTHORITIES AND REFERENCES | 29 |
| | A. Authorities | 29 |
| | B. References | 29 |
| VIII. | ACRONYMS AND ABBREVIATIONS | 29 |
| IX. | GLOSSARY OF TERMS/DEFINITIONS..... | 31 |

LaGrange County Local Emergency Planning Committee
Hazardous Materials Emergency Response Plan

| | |
|--|------------|
| X. APPENDICES | 35 |
| APPENDIX 1 - LAGRANGE COUNTY PRIMARY RESPONSE AGENCIES/HAZMAT RESPONDERS | 35 |
| APPENDIX 2 - POLICE, AMBULANCE, AND FIRE LOCATIONS | 36 |
| APPENDIX 3 - PIPELINE, RAILROAD, AND TRANSPORTATION ROUTES | 39 |
| APPENDIX 4 - EHS FIXED FACILITY VULNERABILITY ZONES AND EVACUATION ROUTE..... | 44 |
| APPENDIX 5 - EHS FIXED FACILITIES INFORMATION AND FACILITY EMERGENCY COORDINATORS (FECs)..... | 50 |
| APPENDIX 6 – NON-EHS FIXED FACILITY VULNERABILITY ZONES AND EVACUATION ROUTES | 52 |
| APPENDIX 7 - NON-EHS FIXED FACILITIES INFORMATION AND FACILITY EMERGENCY COORDINATORS (FECs)..... | 66 |
| APPENDIX 8 - TRAINING AND EXERCISE PROGRAM/SCHEDULE | 69 |
| APPENDIX 9 –MEDIA CONTACTS | 76 |
| APPENDIX 10 - POPULATION PROTECTION INFORMATION (SHELTER-IN-PLACE AND EVACUATION) | 78 |
| APPENDIX 11 - EXERCISE EVALUATION FORMS/CHECKLISTS | 82 |
| APPENDIX 12 - PUBLIC ADDRESS ANNOUNCEMENT SAMPLES | 86 |
| APPENDIX 13 - LAGRANGE COUNTY LEPC MEMBERSHIP ROSTER | 94 |
| APPENDIX 14 - COUNTY/CITY/TOWNSHIP CONTACT NUMBERS | 95 |
| APPENDIX 15 - CHEMICAL EMERGENCY NOTIFICATION REPORT | 96 |
| APPENDIX 16 - RESOURCE LIST FROM COUNTY EMERGENCY RESPONSE TEAMS..... | 101 |
| APPENDIX 17 - HAZARDOUS MATERIAL DECISION EVENT TREES | 103 |
| Appendix 18- Evacuation SOG..... | 104 |

I. INTRODUCTION

Major emergency hazardous materials (HazMat) incidents/accidents require activation of the Local Emergency Planning Committee (LEPC) to provide coordination between agencies. This includes agencies within and outside LaGrange County. It is essential that response agencies understand the use of an integrated Incident Command System (ICS) under the National Incident Management System (NIMS). The inclusion of support agencies will increase the need for coordination during the emergency. If the local capabilities are overwhelmed, support may come from other jurisdictions such as mutual aid partners as well as State or Federal agencies. The use of these resources may be directed by the Emergency Operations Center (EOC) depending on the type of incident/accident and the level of response.

A. Scope of Hazardous Materials Response

LaGrange County is continually at risk from a HazMat incident. The number of fixed sites using hazardous materials locally relatively light, but the county is still vulnerable to accidents involving these materials. Release of hazardous materials can come from fixed sites but is more likely to occur from transportation incidents on the toll road, highways and/or railroad in the county.

This Plan was developed to help LaGrange County officials and first responders prepare and respond to HazMat incidents. These plans and procedures recognize LaGrange County emergency response agencies do not have the resources to respond to a serious HazMat incident such as a Level II or III incident. A Level III incident is defined as full emergency situation and involves severe potential exposure for the responders and the general public.

B. Purpose

Primary responsibility for the safety and welfare of the residents of LaGrange County rests with the respective local governments as well as city and county officials. This Plan is based on a response at the lowest level of government; however, the Indiana Department of Homeland Security (IDHS) may be called on to assist by providing State resources. The IDHS will coordinate State agencies, and if deemed necessary, request a Presidential Declaration through the Federal Emergency Management Agency (FEMA). This type of declaration allows supplemental Federal financial and technical assistance.

The primary purpose of the Plan is to provide effective, coordinated emergency response to incidents involving the release or potential release of hazardous materials in LaGrange County. This *Hazardous Materials Emergency Response Plan* will also serve as an Annex to the LaGrange County *Comprehensive Emergency Management Plan (CEMP)* under the guidelines of the Superfund Amendments and Reauthorization Act (SARA) Title III. This Plan provides assurance of appropriate response to protect the population, property, and environment of LaGrange County in the event of a HazMat incident involving transportation, use, storage, or possession of hazardous materials.

For the purposes of this Plan, hazardous materials are defined as any chemical which is a physical hazard or a health hazard as defined under Occupational Health and Safety Administration (OSHA) 29 Code of Federal Regulations (CFR) 1919.120 and 1910.1200 and as defined in this document. In addition, radioactive and non-radioactive materials and explosives in reportable quantities, as well as other chemical hazards, are included as hazardous materials.

The LaGrange County LEPC shall strive to increase the public's knowledge and access to information regarding the presence of hazardous materials/chemicals in their communities and the releases of them into the environment.

C. Situations and Assumptions

I. Situation

LaGrange County encompasses 379.6 square miles, and is located in the northeastern corner of Indiana, bounded on the north by the state of Michigan, on the west by Elkhart county, on the east by Steuben county, and its southern boundary embraces Noble county

LaGrange County has several levels of government including the County Board of Commissioners, and the Town Councils of LaGrange, Topeka, Shippshewana, and *Wolcottville. (Note: *This town is unique, as it also crosses into Noble county).

According to the 2020 census, the population of LaGrange County is 40,446; up 8.9% from the 2010 census. The highest concentration of residents reside in LaGrange (2,789), followed by the towns of Wolcottville (974), Shippshewana (946), and Topeka (933), with the remaining spread out in the rural areas.

LaGrange County travel is served by Interstate 80-90 (Indiana Toll Road), US Highway 20, and state highways 3, 5, 9, and 120. The Indiana Northeastern Railroad (INE) runs in a east-west direction in the southeastern, bottom part of the county, crossing from Helmer (Steuben county) to the town of South Milford. Buckeye Partners, LP, and ANR Pipeline Company have pipelines dissecting the county.

In addition to LaGrange County and town governments, township trustees are located in the following eleven (11) townships: Bloomfield, Clay, Clearspring, Eden, Greenfield, Johnson, Lima, Milford, Newbury, Springfield and Van Buren. Likewise, there are numerous emergency response agencies within the county's boundaries:

- a. The local Parkview Emergency Medical Service (EMS) agencies include a well-staffed and trained cadre of personnel located throughout the county, ranging from basic EMTs to Paramedics. (see Appendix 2).
- b. Seven town/township fire departments
- c. Five law enforcement agencies and one State Police Post at 5811 Ellison Rd, Fort Wayne, IN (Allen County), serves the county residents
- d. One major dispatch center (LaGrange County 911 Dispatch Center)
- e. The Emergency Operations Center (EOC) and the County's 911 Dispatch Center are co-located at the LaGrange County Sheriff's Department 0875 S State Road 9, LaGrange, IN. There is a second Emergency Operations Center (EOC) located at 180 Crossfire DR. Topeka, IN. The county's Emergency Management Agency operates out of 105 N High St. LaGrange, IN.

There are a small number of fixed site facilities reporting hazardous chemical substances. Nevertheless, planning for each individual facility should be carried out doing a Hazard Analysis. Fixed site facilities report present levels of inventories via Tier II forms. Analysis of these forms indicate storing and/or processing hazardous materials pose an overall limited threat to the general population of LaGrange County.

There are 6 extremely hazardous substances (EHS) fixed facilities in the county that are subject to the requirements of SARA Title III and will participate in the planning and Right-to-Know provisions of the law. The EHS companies and their EHS chemicals are

LaGrange County Local Emergency Planning Committee
Hazardous Materials Emergency Response Plan

those facilities that are listed in orange and marked with an asterisk (*) in the 'Facilities and Chemicals Table' below (the remaining ones are Non-EHS chemical facilities):

| TIER II FACILITIES (EHS* FACILITIES IN ORANGE COLOR) | CHEMICALS AT FACILITY (EHS* IN ORANGE) |
|---|---|
| AT & T Communications 3230E – US20 LaGrange IN 46761 | Sulfuric acid (batteries) |
| Ferrellgas 430 N Van Buren Street Shipshewana IN 46565 | Propane |
| | |
| Hoosier Propane – (Shipshewana) 1200 N Van Buren Street Shipshewana IN 46565 | Propane |
| Hubbard Milling Company 135 Main Street Shipshewana IN 46565 | Sodium selenate Cobalt carbonyl Urea 287 |
| ITR Concession Co, LLC LaGrange Maintenance Facility 7200N-600W Shipshewana IN 46565 | Diesel Gasoline |
| ITR Concession Co, LLC Gene Stratton Porter Travel Plaza 7S 7065 N-475 E Howe IN 46746 | Diesel Gasoline Ferric Chloride |
| ITR Concession Co, LLC Ernie Pyle Travel Plaza 7N 5000 E-750 N Howe IN 46746 | Diesel Gasoline |
| ITR Concession Co, LLC Howe-LaGrange Toll Plaza 7880 N State Road 9 Howe IN 46746 | Diesel Gasoline |
| LaGrange Compressor Station (ANR Pipeline Company) 2255 W – US 20 LaGrange IN 46761 | Ethylene glycol Lubricating oils Methanol Natural gas condensates |
| Nishikawa Standard Company 324 Morrow Street Topeka IN 46571 | Ethylene/propylene Copolymer Solvent-refined residual oil Sulfuric acid (batteries) Carbon Black Lead Raw EPDM Rubber |
| North Central Coop 0955W – US 20 LaGrange IN 46761 | Gasoline Fuel oil Kerosene Propane |

LaGrange County Local Emergency Planning Committee
Hazardous Materials Emergency Response Plan

| TIER II FACILITIES (EHS* FACILITIES IN ORANGE COLOR) | CHEMICALS AT FACILITY (EHS* IN ORANGE) |
|--|---|
| N & M, Inc. 7100 N – 600 W LaGrange IN 46761 | Ammonia Hydrogen Sulfide |
| Shipshewana IN WCG (Level 3 Communications) 8210 W – US 20 Shipshewana IN 46565 | Sulfuric acid (Batteries) |
| Gas America 720 S Van Buren St Shipshewana, IN 46565 | Kerosene E-85 gasoline |
| Lassus Handy Dandy 400 North Main Wolcottville, IN 46795 | Kerosene |
| Therma Tru 8055 N SR 9 Howe, IN 46746 | Hydrogen Sulfide |
| Lund Industries 7225 N SR 9 Howe, IN 46746 | Argon |
| Town of Topeka (Water Plant) Pleasant Ave. Topeka, IN 46571 | Chlorine |
| JW Billman and Son 1560 N SR 9 LaGrange, IN 46761 | Propane |

For response to a Haz-Mat incident, LaGrange County's emergency response resources currently does not consist of any Haz-Mat team, thus limiting their capabilities to respond to any local incident. If the response requires more than the county resources, the county will seek assistance from adjoining area's hazmat teams, as well as additional outside resources with the private sector and/or State and Federal government agencies.

2. Assumptions

- Proper implementation of this Plan and its supporting procedures will reduce or prevent releases and related exposure to the public, as well as a reduction or prevention of damage to the environment.
- The greatest threat of a Haz-Mat incident in LaGrange County is posed by accidents along the major transportation routes, and at a few industrial facilities. Such incidents are more likely to affect larger segments of the general population in the county. At most risk are the towns of LaGrange, Shipshewana, Topeka and Wolcottville, as well as Interstate 80/90, US Highway 20, and State Roads 3, 5, 9, and 120.
- Some parts of the county are located within the flood plains of the Pigeon and Fawn Rivers, resulting in occasional flooding; with additional flooding problems possible from the numerous lakes located through the county. Flooding can result in some

run-off of agriculture chemicals and petroleum products into the county's rivers, streams, and lakes.

- d. Protective actions for the general population may include in-place sheltering and/or evacuation. Traditionally, many of the residents in the risk area will evacuate to private homes or shelters of their own choosing outside the affected area.

D. Concept of Operations

1. General

LaGrange County's emergency response agencies have limited capability to respond to Haz-Mat releases, as many local fire department personnel are currently trained only through the Haz-Mat Operations level. Therefore, the local county fire departments will utilize their resources to assess the effects of the Hazmat release and effect all subsequent actions to contain the release/spill. Additional assistance is sought from nearby counties for hazmat incidents when needed, and they are requested through the 911 Dispatch Center. The Kendallville Fire Department (Noble County), the Angola Fire Department (Steuben County) and Elkhart Fire Department (Elkhart County) have haz-mat teams, and will respond when requested for mitigating hazardous material incidents in LaGrange County.

The County Commissioners adopted the National Incident Management System (NIMS) on March 6, 2006 as the basis for the county's ICS. As such, the county should be in compliance with NIMS directives and the National Response Framework (NRF), and eligible for Federal grants.

2. Emergency Classification Levels

The classification levels of Haz-Mat incidents differ from the emergency classifications generally found in most *All-Hazard CEMPs*. In a Haz-Mat incident, the response is based upon the characteristics of the chemical involved, the size or potential size of the spill, and the threat posed to life, property, and the environment.

Level I – Probable Emergency Conditions. No evacuation is necessary other than from the immediate scene. The level of the incident does not pose a chemical exposure hazard to first responders from fire services using dermal and respiratory gear. Examples of Level I incidents are: minor releases of fuel from vehicular accidents; small releases of corrosives and illegally discarded chemical containers that are not in danger of releasing substances. Normally the county EOC is not activated.

Level II – Limited Emergency Situation. An incident involving a greater hazard or larger area that poses a potential threat to life or property and which may require a limited evacuation of the surrounding area. This incident may require outside assistance to stop the release. Examples of this level are: releases of significant quantities of volatile organics at a fixed facility or a transportation or storage cargo tank release. In this situation the county EOC will normally be partially staffed.

Level III – Full Emergency Situation. This type of incident/accident involves severe potential exposure for the responders or the general public. Mitigation may require a large-scale evacuation or proper sheltering-in-place. Response will include the expertise or resources of private industry, mutual aid partners, as well as State or Federal government agencies. The county EOC will be fully staffed and operational.

E. Organization, Responsibilities, and Assignment of Tasks

1. Organization and Responsibilities

- a. **Local Government.** The President and members of the LaGrange County Commissioners (as County Chief Executives) have overall responsibility for hazardous materials preparedness in LaGrange County.
- b. **Local Emergency Planning Committee.** The LEPC was formed in accordance with the Indiana Emergency Response Commission (IERC) guidelines and the Community Right-to-Know Act of 1986. The LEPC is responsible for coordinating activities among signatory agencies to protect the public health and environment during and following a Hazardous Material incident.
- c. **Emergency Response Agencies.** The appropriate emergency response agencies respond to a Haz-Mat incident as directed by the *LaGrange County Hazardous Materials Emergency Response Plan*. Each agency has the responsibility to develop and maintain their individual standard operating procedures (SOPs) based upon their task assignments in this Plan. They also have the responsibility to ensure that their department head or designated alternate has the authority to commit their resources.

2. Task Assignments for Response and Government Agencies

- a. **LaGrange County Elected Officials.** The LaGrange County LEPC has designated an individual as the Community Emergency Coordinator (CEC). For LaGrange County and all political subdivisions this representative is currently established as the LaGrange County Director of Emergency Management, emergency contact phone # 260-463-1176 (cell), or 911.
- b. **LaGrange County Community Emergency Coordinator (CEC)**
 - 1) The LaGrange County CEC maintains day-to-day operations in his primary position as the Director of Emergency Management, and as CEC responds to serious chemical incidents.
 - 2) The LaGrange County EMA Director, as the county's designated leader for emergency management oversight, also coordinates ever-day policy to allow administrators and chiefs with the technical skills and authority to be responsible for incident management in the event of a Hazardous Material incident.
 - 3) The County EMA Director also coordinates with and advises responsible county and city officials, administrators and department heads, to assist in taking adequate measures to protect the general public, property, and the environment.
- c. **Local Emergency Planning Committee (LEPC)**
 - 1) The LEPC holds scheduled meetings to establish short- and long-range plans regarding the county's Haz-Mat emergency response and preparedness program.
 - 2) The committee compiles, or causes to be compiled, the annual Hazardous Materials Reports for LaGrange County based upon Tier II reporting. This includes an update of the reports from fixed facilities.
 - 3) The LEPC develops and maintains this *Hazardous Materials Emergency Response Plan* as part of the *LaGrange County CEMP*.

- 4) The committee outlines methods, as needed, and schedules training and exercises on hazardous materials in coordination with local government officials, academic institutions and instructors, local emergency response agencies, and available private participants.
- 5) The LEPC serves as the point of contact for Community Right-to-Know activities.
- 6) The committee responds to requests for information from private and public entities or directs requests to the correct agencies.
- d. **County Attorney**
 - 1) The county attorney acts as legal advisor on items related to public health and safety.
 - 2) The attorney assists in resolution of legal problems that may arise due to SARA Title III implementation or specific chemical release incidents.
 - 3) The county attorney initiates any legal action against responsible parties for a hazardous material release when determined to be necessary.
- e. **Incident Commander (the fire chief or highest ranking fire department officer at the scene trained for hazmat-related incidents)**
 - 1) This person takes charge as the on-site Incident Commander (IC), and implements ICS as trained for in accordance with NIMS.
 - 2) The IC directs response operations after receiving input from the Haz-Mat Teams including the:
 - Establishment of site security areas and hazard exclusion zones within the hazardous sector once the nature of the hazardous material is determined.
 - Activation of the response chain as shown in Section II – Response Functions. This is based upon estimates of likely harm.
 - 3) The IC coordinates with all public and private agencies on-site at the Incident Command Post (ICP) and provides information, as necessary, for law enforcement, emergency management, medical authorities, and others regarding the hazards and risks posed by the chemical(s) spilled.
 - 4) The IC develops and maintains the fire department's Hazardous Material response procedures for their fire district.
 - 5) The IC provides appropriate public information releases to the media concerning the Haz-Mat response, or designates the emergency management public information officer (PIO) to make such periodic releases.
 - 6) The IC has the authority to direct the overall operations including decontamination, selection of mitigation concepts and methods, identification of safety zones, and resolution of conflicts in accordance with their respective agency SOPs.
 - 7) It is the responsibility of the IC to recommend evacuation actions after coordination with all involved agencies and discussion with the appropriate elected officials (when possible). This will ensure every effort is made for proper warning, transportation, shelter, and care of all evacuees.
- f. **County Public Information Officer (PIO)**

- 1) The PIO works with the IC on press releases.
- 2) The PIO schedules and provides press briefings in secure location(s).
- 3) The PIO establishes incoming and outgoing communication at the press briefing area.

g. All Emergency Response Agencies

- 1) Each emergency response agency shall report to the IC upon arrival for coordination of activities and shall stand by at the designated staging areas until needed.
- 2) The cleanup, removal, and disposition of contamination are the responsibilities of the manufacturer, carrier, or storage facility who released the materials. Assistance in removal, disposal oversight, and some technical considerations may be obtained through the Indiana Department of Environmental Management (IDEM) at 888-233-7745 or the U.S. Environmental Protection Agency (EPA), Region 5 at 312-353-2318.
- 3) Coordinate with the IC to recommend evacuation actions.
- 4) A post-incident analysis report and critique shall be the responsibility of the IC with input solicited from all involved agencies. Copies of the report shall be provided to the LaGrange County EMA Director within 30 days of incident stabilization for review, conducting further debriefs, plan modifications, and future use in training and exercise programs.

h. Haz-Mat Response Teams

- 1) The responding Haz-Mat Team maintains and utilizes their own individual SOPs when responding to a haz-mat incident, which they carry in their response vehicles. Their SOPs address determination and establishment of safety zones, decontamination procedures, a listing of guidance documents, personal protective actions, and the role of each responder on the team.
- 2) The team(s) provides assistance in identification and control of the hazardous material(s).
- 3) The team(s) make appropriate protective action recommendations to the IC, including evacuation of the area and on scene safety.
- 4) Upon request of the IC, team members will obtain samples from the release area. However, the responsibility for identification of samples rests with the jurisdiction.
- 5) The team(s) will keep an accurate accounting of expendable materials used at the scene.
- 6) The team(s) will work through the Joint Information Center (JIC), when activated, for any news release or information provided to the news media.

i. Fire and Rescue

- 1) Fire and rescue personnel will provide services consistent with training at the First Responder Operations Level utilizing available protective gear.
- 2) Fire and rescue personnel will contain the release from a safe distance to keep it from spreading and to prevent exposure.

- 3) Fire and rescue personnel will provide site support for Federal, State, or privately dispatched Haz-Mat Teams in the contamination control, decon, and safe zones.
- j. **Law Enforcement**
 - 1) Law enforcement personnel will support field operations at the ICP consistent with First Responder Awareness Level training which is provided as part of Police Officer Training Standards.
 - 2) Law enforcement will establish evacuation routes and traffic control for the area affected by the incident.
 - 3) After consultation with the IC, law enforcement personnel will implement the order to evacuate affected areas.
 - 4) Law enforcement personnel will maintain security for area businesses and residences.
- k. **Emergency Medical Service Organizations**
 - 1) EMS agencies will provide medical support to the ICP consistent with First Responder Operations Level training and in accordance with their internal SOPs.
 - 2) EMS personnel will triage, treat, and transport victims to area medical facilities.
 - 3) EMS personnel will provide necessary medical surveillance of emergency response personnel in the exclusion zone.
 - 4) EMS personnel will utilize ambulance decon and isolation procedures when required prior to any transport for hospital admission.
- l. **Local Hospitals**
 - 1) The county's lone hospital has a 25 bed capacity. Parkview-LaGrange Hospital, 207 North Townline Road, LaGrange, IN (phone 260-463-9000), depends on outside resources for pre-admission, off-site decontamination. They have a decon room alongside their ambulance bay entrance for initiating decon. Additionally, a portable decon unit has also been purchased and available for future use. The hospital's haz-mat SOPs are located at the Nurses Station in the emergency room (ER), and all ER nursing staff and key personnel are in the process of being trained in procedures such as decon and for dealing with contaminated patients prior to admission. Nevertheless, the local hospital staff are dedicated and prepared to provide medical treatment to affected citizens and emergency response personnel as needed.
- m. **LaGrange County Board of Health**
 - 1) LaGrange County Board of Health has a person assigned to the position of Environmental Health Officer. This staff member shall respond to any serious Haz-Mat incident when requested by the IC, CEC, or an EMA official.
 - 2) The Environmental Health Officer (representing the County Public Health Officer) is available to act as a liaison for emergency management officials with State and Federal officials when an incident poses a threat to community health. Local public health personnel can be reached via phone at 260-499-4182.
- n. **State and Federal Support**

Planning, training, and on site assistance are available through the following State and Federal agencies: the Indiana Department of Homeland Security (IDHS), Indiana Department of Environmental Management (IDEM), Department of Fire and Building Services (DFBS), Federal Emergency Management Agency (FEMA), the US Environmental Protection Agency (EPA), and the National Response Center (NRC).

o. Private Sector Support

1) General

- a) Designate personnel available and capable of responding to Haz-Mat emergencies. Update information as personnel and training levels change.
- b) Maintain an Emergency Response Duty Roster which designates personnel available on a 24-hour basis. Update as necessary.
- c) Adhere to the provisions of the *LaGrange County Hazardous Material Emergency Response Plan*.
- d) Channel on site media communication through the designated PIO or IC.
- e) Coordinate and cooperate with the directions of the IC at the scene.
- f) Educate and train personnel in Haz-Mat response on a continuing basis in accordance with 29 CFR 1910.120 and/or National Fire Protection Association (NFPA) 471, 472, and 473.
- g) Participate in post-incident evaluations to aid in future prevention and enhance emergency response operations.
- h) Conduct and participate in exercises using the *LaGrange County Hazardous Materials Emergency Response Plan*.
- i) Develop SOPs/standard operating guidelines (SOGs) for response to Haz-Mat incidents which as a minimum include:
 - i. Definition and assignment of the basic command functions, including the method of assuming and continuing command.
 - ii. For areas and functions, definition of the command methodology that includes the division of responsibilities through delegation of authority to officers.
 - iii. Description for all aspects of communications and dispatch.
 - iv. Definition of tactical priorities and related support functions.
 - v. Definition of methods for resource deployment.
 - vi. An outline of responsibilities and functions of the agency and its supporting units.
 - vii. Identification of immediate actions to safeguard public health and safety as well as the environment.
 - viii. Development of emergency response evaluation criteria to determine the presence of a hazardous chemical, biological, or radioactive material.
 - ix. Identification of safety procedures for responders.
 - x. Definition of on scene operations for first responders.
 - xi. Provision of participants, personnel, technical expertise, and equipment support during chemical hazard exercises and training activities.

- xii. Notification of a Haz-Mat incident to the LaGrange County 911 Dispatch Center. Provide the dispatcher with all appropriate information to complete the Chemical Emergency Notification Report (see Appendix 15) including the chemical name; whether the substance is classified as an EHS; estimation of the quantity released; time and duration of the release; location of release (air, water, land); known/anticipated acute or chronic health risks associated with the emergency; proper precautions (evacuation or in-place sheltering); and the name and phone number of the contact person. Provide safe routes of entry into the site for emergency response personnel.
- 2) Fixed Facilities
 - a) Fixed facility operators shall designate a minimum of two Facility Emergency Coordinators (FECs) responsible for assisting in the implementation of this Plan and the preparation of comparable on site contingency plans. The plans will include specific responsibilities, notification, emergency response procedures, and available resources. Additionally, the plans will establish the training required and the current levels of training for the facility's response personnel.
 - b) Fixed facility operators shall provide technical support, as requested, in the development of off-site risk assessments, evacuation probabilities, and contingency planning. They will identify any inside/outside release detection mechanisms that are currently used by the fixed facility. If other detection mechanisms are established or utilized at a later time, the facility must advise the LEPC.
 - c) The facility shall provide continual technical support to the IC for the duration of the incident.
 - d) Fixed facility operators shall notify appropriate officials/agencies of a Haz-Mat release incident as directed by Federal and State regulation.
 - 3) Pipeline Operators. Pipeline operators are responsible for a plan that outlines the general actions and establishes policies to be followed in the event of a Haz-Mat incident. They shall make copies of the plan available to the LaGrange County LEPC.
 - 4) Rail and Highway Carriers
 - a) Rail and highway carriers will develop a *Chemical Incident Response Plan* and make copies available to the LaGrange County LEPC.
 - b) Rail and highway carriers shall maintain a response capability in the event of a Haz-Mat incident involving their transported load.
 - c) Rail and highway carriers will provide prompt and proper identification of all hazardous materials carried.
 - d) Rail and highway carriers shall provide a list of major hazardous materials shipped over the rail systems through the county, and update this list on an annual basis.

F. Relationships to Other Plans

1. The *LaGrange County CEMP* is the underlying document for the protection of the health, safety, and property of LaGrange County citizens from all natural and man-made disasters.
2. The *LaGrange County Hazardous Materials Emergency Response Plan* as a part of the overall *CEMP* provides procedures to protect the public from Haz-Mat incidents occurring during transport or at storage facilities, fixed sites, and transfer points.
3. LaGrange County's emergency response agencies (i.e., Haz-Mat teams, fire, law enforcement, emergency medical service organizations, emergency management, and medical facilities) have entered into various mutual aid agreements that increase the county's overall response capability.
4. The State of Indiana has developed a *Hazardous Materials Emergency Response Plan* which outlines the appropriate State agencies responsibilities during Haz-Mat emergencies that exceed a county's capability.
5. The NRF provides for a coordinated Federal response to a large-scale Haz-Mat incident. The NRF is activated at the Federal level by request from the on scene IC to the local EOC for a fixed facility incident, or through the shipper in the case of a transportation-related emergency. Following that initial request the local EOC will notify the State EOC of the situation and request NRF activation. The State EOC will make the request at the Federal level through FEMA. **Note: The National Response Program has been updated and newly designated as the 'National Response Framework' (NRF).**

II. RESPONSE FUNCTIONS

A. Emergency Response Notification Summary

1. When a Haz-Mat spill occurs, notification to the LaGrange County 911 Dispatch Center, or local police or fire department may come from any of the following sources:
 - A citizen
 - A fixed facility
 - A county or city department/agency (such as the highway or health department)
 - A county or city emergency response agency
2. The 911 dispatchers receiving Haz-Mat notification must give priority to alert the fire department in the appropriate jurisdiction. The dispatcher must then try to maintain contact in order to obtain as much of the following information as possible from the notification source or the first responders on scene.
 - Identification of the caller
 - What happened to cause the situation
 - Location and time of incident
 - Injuries (if any)
 - Chemical name of released substance (identification on placard)
 - Estimated quantity released

LaGrange County Local Emergency Planning Committee
Hazardous Materials Emergency Response Plan

Time and duration of release

Media into which the release occurred (water, air, soil, etc.)

Type and condition of containers

Known or anticipated acute or chronic health risks associated with the hazard

Recommended precautions such as evacuation distances

Shipping information (in a transportation incident)

First estimate of response level (see Section I.D.2, and the Levels of Response chart below)

3. Depending upon the classification of the incident, many emergency response functions may be necessary for the appropriate response. Notifications will be made in accordance with procedures found in the *LaGrange County CEMP*. If a determination is made that a release exceeds the reportable quantity the spiller must notify the IDEM at 888-233-7745 or 317-233-7745. Figure II-1 describes incident levels and appropriate responses to be initiated by the 911 Dispatcher, IC, and/or the CEC.

| EMERGENCY CLASSIFICATION LEVEL | ACTIVATE | STANDBY | NOTIFY |
|--|--|---|--|
| I. PROBABLE EMERGENCY CONDITIONS. No evacuation is necessary other than from the immediate scene. The level of the incident does not pose a chemical exposure hazard to first responders from fire services using dermal and respiratory gear. | Fire Department and Law Enforcement | EMS (and advise the CEC & EMA) | If required, IDEM (by spiller); Shipper; CHEMTREC (Transportation); NRC (fixed site) |
| II. LIMITED EMERGENCY SITUATION. An incident involving a greater hazard or larger area that poses a potential threat to life or property and which may require a limited evacuation of the surrounding area. This incident may require outside assistance, if necessary, to stop the release. | Fire Department, Law Enforcement, and EMS; EMA for partial EOC activation; advise the CEC | Mutual aid Agencies, Highway Dept., County Public Health, American Red Cross, and other Human Services Agencies | IDEM (by spiller); Shipper; CHEMTREC (Transportation); NRC (Fixed Site) |
| III. FULL EMERGENCY SITUATION. An incident/accident involving severe potential exposure for the responders or the general public. Mitigation may require a large-scale evacuation or proper sheltering-in-place. The county EOC is fully staffed and operational. | All Level II and III Mutual aid Agencies, IDEM, EPA, CEC, IDHS for large scale outside support; and local agencies (for evacuation, shelter, etc.) as needed under the <i>CEMP</i> | N/A | N/A |

Figure II-1.

4. The 911 dispatcher then alerts law enforcement, EMS, and the LaGrange County CEC & EMA; see Figure II-2, passing on the above information to all responding units, along with known wind direction and speed. When the ICP is established at the site, in accordance with NIMS, the IC will determine the response level and

resources needed for the event and implement the response functions described in this Plan.

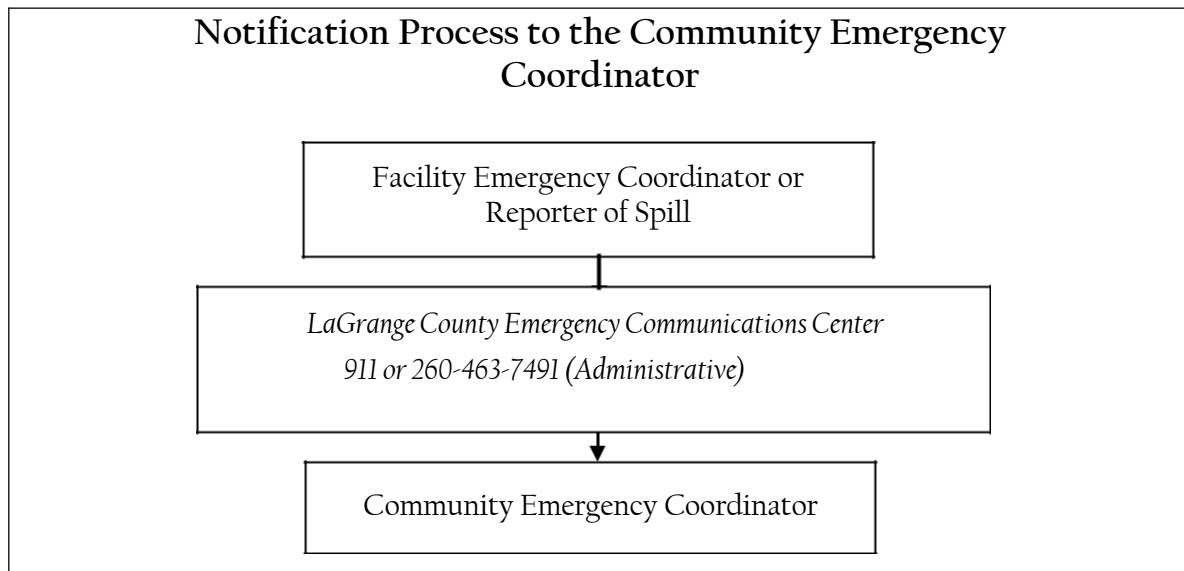
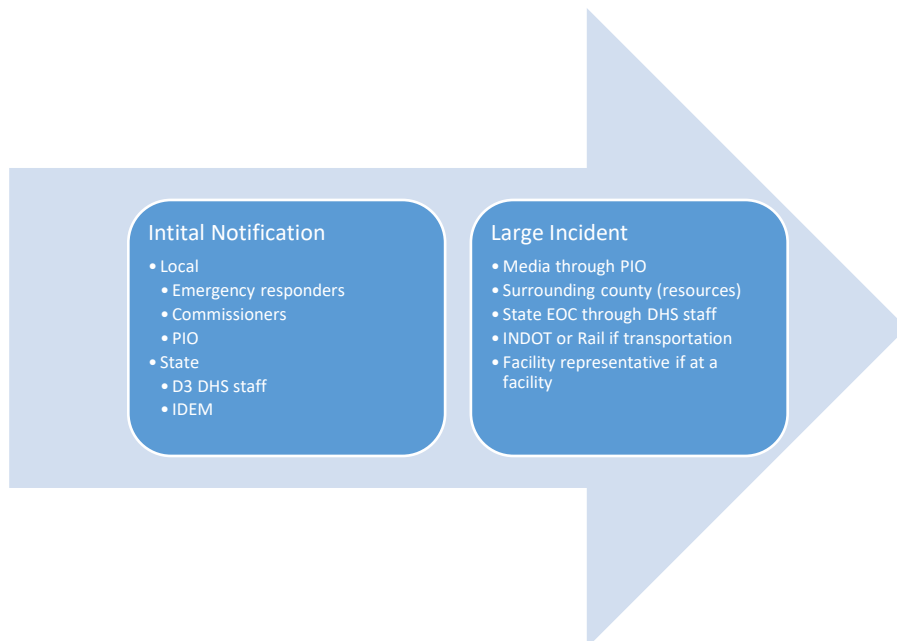

Figure II-2.

5. Public warnings will be issued in accordance with procedures set forth in the *LaGrange County CEMP Operations Section, Emergency Support Function (ESF) 2 - Communications and Warning*.



Communications will be made via face to face, phone/cell phone and/or radio communications.

B. Public Protection Options

1. **Evacuation.** Evacuation can be completely effective and safe if accomplished prior to the arrival of a toxic cloud (see the *LaGrange County CEMP Human Support Section, ESF 13 – Evacuation*).
2. **Sheltering-In-Place.** In some cases, advising people to stay indoors and attempting to reduce air flow into a structure may be the most effective protective action.

3. **Ingestion Advisory.** Food crops and drinking water may be contaminated by a chemical release in certain situations; therefore, the public must be warned of a threat to the food and/or water supplies.
4. **Sewage and Run-Off.** A hazardous chemical release may contaminate sewage systems or area streams and lakes. Such contamination could create a public health threat and cause serious environmental problems.

C. Direction and Control

1. **The Incident Command System.** The command structure linking the ICP and the EOC is the Incident Command System. The Direction and Control function is the combined capability of the ICP and the EOC in a larger-scale chemical emergency such as a Level II or Level III situation. The IC will maintain control of the scene; coordinate all actions related to the incident; and assign specific responsibilities to the ICP and EOC, as necessary. Responders to a HazMat emergency in LaGrange County will operate under ICS in accordance with NIMS.
 - a. To achieve the most efficient response, LaGrange County has been divided into the 7 fire jurisdictions listed below:

LaGrange County Local Emergency Planning Committee
Hazardous Materials Emergency Response Plan

Howe Fire Department
Johnson Twp Volunteer Fire Department
LaGrange Fire Department
Mongo Volunteer Fire Department
Shipshewana Fire Department
Stroh Volunteer Fire Department
Topeka Fire Department

Each Fire Chief or designee/highest ranking officer of the above departments has the authority to release supplies and equipment to assist other jurisdictions if needed based upon mutual aid agreements.

- b. Additionally, since the county does not have a Level A HazMat team or stand-alone unit with decon and detection/monitoring capabilities, mutual aid will be used to request assistance from outside the county for any county hazmat incidents requiring a response.
 - 1) In the event of a HazMat incident, the fire chief of the primary responding fire department, or his designee, will assume the position of IC. In his absence the position of IC will be taken by the highest ranking fire department officer present trained in hazardous material command.
 - 2) All ICs should seek to be qualified at the advanced ICS level.
 - 3) First responders from the fire departments listed above should become qualified at the First Responder Operations Level and at the Basic ICS level.
 - 4) Personal protective equipment (PPE) available to LaGrange County first responders consists of structural firefighters' protective clothing together with positive pressure self-contained breathing apparatus (SCBA). The county's firefighters should be qualified at the HazMat Operations level as a minimum. Each team's equipment will provide the maximum level of personal protection at Level B with positive pressure SCBA. This protection is limited to a range of chemicals listed in the *US Department of Transportation (DOT) Emergency Response Guidebook (ERG)*.
 - 5) When an incident is classified as a Level III magnitude HazMat emergency and the IC finds it is beyond the capabilities of the combined county's firemen and emergency response agencies, he/she will request appropriate assistance through the LaGrange County EOC, or at the State or Federal level.
 - 6) In preparation for logistical support from outside assistance and consequence management, the IC must contact the EMA Director, who will activate the EOC, as necessary. **If the county EMA cannot be contacted or the EOC is not activated, the state EOC can be reached 24/7 at 800-669-7362 for needed assistance.**
2. **Incident Command Post.** The purpose of the ICP is to provide an on-site unified command of all participating agencies to ensure coordinated operations, simplification of communications, performance of logistical tasks, and to assist the IC with the overall management of the incident activities.
3. **Emergency Operations Center.** The LaGrange County EOC, which is isolated by distance from the pressures of ongoing response efforts at the scene, has basic administrative and technical capabilities and will be the focal point for coordination of resource requirements in support of both on site and off site activities.
 - a. **On Site Support.** The EOC will: (1) coordinate local resources with the HazMat Teams in transit to the emergency; (2) transmit and follow up on requests for mutual

aid or public works assistance; and (3) maintain records to track incoming resources and optimize use of available communications.

- b. Off Site Support. The EOC will coordinate evacuations, sheltering, public health issues, and social services assistance as well as assist in maintaining financial records of the event.
- c. The LaGrange County EOC is the preferred site: (1) for collection, evaluation, display, and dissemination of information on the current status; (2) to aid in executive decision making; (3) to track costs; and (4) to provide documentation for investigative follow up. The LaGrange County EOC is located at 0875 S State Road 9, LaGrange, Indiana. For a large hazardous chemical release the LaGrange County EMA can request mutual aid assistance with neighboring counties to provide other needed support resources.
- d. The LaGrange County Emergency Management Director is in charge of EOC operations and will maintain close coordination with the IC. The Incident Commander, at his discretion, may assign ICS personnel to the EOC for liaison or functional assignments and ease of ICS operations.

D. Communications between Responders

During emergency operations, all departments will use their existing equipment and procedures to communicate with their respective field units. The primary communications for the county first responders is with their 800 MHz communications system (with the capability to use tactical event frequencies as needed).

E. Response Personnel Safety

1. **Standard Operating Procedures.** To reduce risks to first responders in the event of a HazMat incident, health and safety SOPs must be developed by each fire department to include:
 - a. Medical surveillance in the safe zone
 - b. Establishment of an exclusion zone
 - c. Personnel protective equipment (PPE)

The county's hazmat team is staffed to provide this type of support to the Hazmat IC.

2. **Medical Surveillance.** An EMT or paramedic, from the responding hazmat teams or from Parkview-LaGrange County EMS organization, is charged with the responsibility for surveillance of the response team for any indicators of the effects of toxic exposure.
3. **Exclusion Zones.** Exclusion zones are the safety perimeters established around a hazardous materials release. They are defined as follows:
 - a. **Hot Zone.** This is the area of maximum hazard. All personnel entering the hot zone must wear prescribed levels of protective equipment. A single entry and exit checkpoint must be established at the perimeter of the hot zone to regulate and account for the flow of personnel and equipment into and out of the zone.
 - b. **Contamination Control Zone.** This zone surrounds the hot zone and is also a restricted area. The level of PPE required is less stringent than that of the hot zone. The decontamination unit (if needed) is located here, as well as the Safety Officer and immediate support and security personnel.

- c. **Safe Zone.** This is the unrestricted area beyond the outer perimeter of the contamination control zone. The ICP, the HazMat Team(s), and support agencies are located in this area.

Exclusion zones should be set up for any HazMat incident. For a Level I incident this can be accomplished at a minimum with a hot zone and an informal ICP. The *ERG* lists many chemicals where SCBA and structural protective clothing provide some protection to permit control of a small release. Release of chemicals where the *ERG* shows that the above protective equipment is not effective must be treated as a Level II incident.

Level II and Level III incidents require establishment of the three tier exclusion zones (hot, contamination control, and safe zones). The actual size of the each perimeter will be determined by the nature of the materials involved, atmospheric conditions, and the magnitude of the incident.

4. **Personal Protective Equipment.** Personal protective equipment that is available to LaGrange County emergency first responders consists of structural firefighters' protective clothing together with positive pressure self-contained breathing apparatus (SCBA). This protection is limited with reference to a range of chemicals listed in the *ERG*. Members of responding HazMat Teams dispatched to enter exclusion zones of a serious hazmat incident occurring in LaGrange County will have Level A or Level B PPE at their disposal because maximum respiratory protection is required when entering environments containing unknown substances - or known substances in unknown quantities.
 - a. Level A protection will be worn when the highest level of respiratory, skin, eye, and mucous membrane protection is needed.
 - b. Level B protection will be selected when the highest level of respiratory protection is needed, but with a lower level of skin and eye protection. Level B protection is the minimum level recommended on initial site entries until the hazards have been further identified.

F. Fire and Rescue

1. When the 911 dispatcher has notified the fire department in the appropriate jurisdiction of an incident involving the release of hazardous materials, the officer in charge of the first unit at the scene shall implement the command structure of ICS in accordance with NIMS.
2. During the initial phase of the incident, the IC shall determine the level of the incident and initiate response activities commensurate with the severity of the incident. Resolution of a Level I, II, or III incident in LaGrange County may require outside assistance by State and/or Federal or private agencies. Notification should be made via the LaGrange County EOC to IDHS at 800-669-7362. The rules for notification are summarized as follows:
 - a. **Transportation Incidents.** It is the shipper's responsibility to initiate emergency response once notified. The IC should locate an emergency response telephone number listed in the shipping papers. If paperwork is not available or accessible call CHEMTREC at 800-424-9300 with as much information as can be obtained (i.e., placard number, labels on container, how to contact the ICP, etc.). CHEMTREC will track down and notify the shipper or the manufacturer of the emergency in progress. At this point responsibility for further action passes to the shipper or manufacturer who will initiate on scene assistance, and notify the NRC at 800-424-8802. In the

interim, the shipper or CHEMTREC can provide guidance to the IC for mitigation at the scene utilizing local response capabilities to the level trained.

- b. Fixed Site Facility Incidents. Chemical incidents occurring within a fixed site facility are the responsibility of the facility's emergency response organization. If control is transferred or if the incident poses a threat outside of the facility the jurisdictional fire department is in charge and will proceed using ICS. The IC will direct facility personnel to remove any chemicals that may increase or catalyze the fire, cause an explosion, create toxic gas releases, or cause environmental damage. For outside assistance when needed, the IC will notify the NRC directly at 800-424-8802. (Note: CHEMTREC is only for transportation-related incidents). The NRC will initiate response through the Federal On Scene Coordinator (OSC) assigned to Indiana.
 - c. Federal On Scene Coordinator. The OSC determines the Federal course of action together with agency support that might be required from the State. The OSC, when on scene, acts as a consultant to the IC. The OSC, however, is in control of and directs all Federal and State agencies at the scene that are committed as part of the NRP.
3. The local FEC must call the LaGrange County Dispatch Center (dial 911) for any reportable hazardous material release.

G. Law Enforcement

1. Law enforcement should be trained to the First Responder Awareness Level at a minimum. Law enforcement responsibilities are handled by the LaGrange County Sheriff's Department or by the city/town police departments within the boundaries of their own jurisdictions. Mutual aid agreements must be in force between all law enforcement agencies and outside support.
2. Law enforcement will maintain on scene control by establishing scene perimeters, access control points, and traffic control points, and directing traffic for evacuees if evacuation routes have been established and activated. The LaGrange County EMA does not currently have the capability to assist with traffic and crowd control.
3. Law enforcement is also responsible for evacuation. The order to evacuate large populated areas should come from the Chief Executive Officer or his designee. When there are time constraints, limited evacuation can be ordered by the IC. The law enforcement agency designated by the IC will direct the evacuation effort and all traffic flow out of the immediate area. The EOC will be advised of the potential need to evacuate as soon as possible so the American Red Cross can be alerted of the potential evacuation and sheltering needs. **The Red Cross will track any evacuees with their established protocol.**
4. The following are general SOP considerations in traffic flow and evacuations:
 - a. Isolate the affected area and permit entry only to the appropriate response personnel.
 - b. Notify residents in the affected area as soon as possible.
 - c. Assist residents in relocation and provide direction out of the area and to open shelters.
 - d. Establish primary and/or secondary evacuation routes based upon prevailing wind, plume area, and most direct route for safe evacuation of affected areas.
 - e. Provide security for evacuated areas and reroute traffic around the affected area.

- f. Coordinate all search efforts for missing or unaccounted people.
- g. Assist in the return of residents upon an “all clear” signal.

H. Emergency Medical Services

1. Emergency medical personnel should be trained to the First Responder Operations Level and are responsible for assigning priorities of medical treatment on the basis of urgency and for transporting casualties from the incident site to appropriate medical facilities. Only members of the HazMat Team under the direction of the Safety Officer can remove victims from the hot zone and supervise on scene decontamination procedures.
2. Emergency medical personnel will provide a liaison between various medical personnel and the IC. They will notify the local hospital regarding what chemicals are involved, and what decontamination and exposure situations will be expected for proper handling and care of victims throughout the triage-treatment-transport process.
3. Emergency medical personnel will maintain a medical assistance advisory role to the Incident Commander regarding signs and symptoms of chemicals involved.
4. The hazmat team will decontaminate victims in the safe zone to ensure proper decontamination prior to triage. They are also responsible to request any required secondary decontamination at the hospital prior to admission if required.

I. On-Going Incident Assessment

1. During the active period of a continuing major release, resources dispatched by the IDHS, IDEM, or the HazMat Team, are responsible to monitor on site quantity, concentration, and movement of spilled material. Based upon their recommendations, the IC must initiate immediate actions in terms of response personnel safety and citizen protection/safety.
2. Decisions dealing with citizen protection/safety on a large scale – particularly those dealing with contamination of food and water supplies as well as structures and soil – must rely on input from specialized technical resources from the local, State, and/or Federal government when dispatched by the EOC.

J. Warning and Emergency Notification

Procedures to warn the public of any highly probable and/or immediate danger are found in the *LaGrange County CEMP Operations Section, ESF 2 - Communications and Warning*.

K. Public Information

Procedures to provide the public with accurate information of the progress of a HazMat incident are found in the *LaGrange County CEMP Operations Section, ESF 17 - Public Information*. In addition, public information announcement samples can be found in Appendix 12. The LaGrange County EMA Director and/or County Sheriff act interchangeably as the County's PIO, and are contacted by telephone at 260-463-1176 (cell) or 911 for EMA and 260-463-7491 or 911, respectively, (for the sheriff) for any HazMat incident. Any status reports of the incident, evacuation, and/or shelter-in-place information shall be disseminated by radio, TV, police and fire scanners, and any other means generally utilized to inform the public.

The LEPC and local response agencies will utilize all or some of the following options to notify the public of a HazMat release and orders for evacuations and/or sheltering-in-place:

Door-to-door notification

Outdoor Warning Sirens (located at the various fire stations)

Radio broadcast

Emergency Alert System (EAS) (Nixle)

Newspaper hotline (when time permits)

Local and regional television stations

L. Personal Protection of Citizens

1. In-Place Sheltering

- a. When the progression of a HazMat incident indicates that segments of the population need to be isolated from a plume, in-place sheltering is the first consideration for protective action.
- b. In-place sheltering moves people out of the open into buildings with doors and windows closed. This type of sheltering is viable when:
 - 1) The nature and concentration of the chemical in the plume is not life threatening. It may however, be quite noxious.
 - 2) The size of the release and given atmospheric conditions will determine the speed of dispersal.
 - 3) When a toxic plume approaches an area so rapidly that a timely evacuation cannot be safely carried out.

In older buildings that have relatively high air leakage rates, it is advisable to shut down air circulation systems (heating systems and air conditioning systems - particularly window-mounted units). In modern energy efficient buildings, air conditioning systems tend to build up positive pressure which counteracts air leakage inside, but only if the fresh air supply is shut off.

- c. Technical input to support a decision ordering in-place sheltering is available from the Table of Initial Isolation found in the *ERG*.

2. Evacuation Procedures

- a. A HazMat incident of sufficient magnitude to trigger an evacuation will most likely come from a transportation related incident. For that reason LaGrange County is not divided into pre-assigned risk zones other than the area fire department jurisdictions previously mentioned. The area at risk must be determined from the actual site of the accident, taking into account the toxicity and magnitude of the release and atmospheric conditions. Information from the *ERG* is invaluable as general guidelines.

- b. Evacuation procedures are organized, phased, and supervised dispersal of people from dangerous or potentially dangerous areas.

Spontaneous Evacuation: Residents or citizens in the threatened areas observe an emergency event or receive unofficial word of an actual or perceived threat and, without receiving instructions to do so, elect to evacuate the area. Their movement,

means, and direction of travel are unorganized and unsupervised.

Voluntary Evacuation: This is a warning to persons within a designated area that a threat to life and property exists or is likely to exist in the immediate future. Individuals issued this type of warning or order are NOT required to evacuate; however, it would be to their advantage to do so.

Mandatory or Directed Evacuation: This is a warning to persons within the designated area that an imminent threat to life and property exists and individuals

- 1) Traffic Routes. Local communities and their law enforcement agencies will be responsible for developing alternate routes around an evacuation area.

- 2) Hospitals. The evacuation plan for hospitals is incorporated in their Joint Commission on Accreditation of Health Care Organizations approved internal emergency operating procedures.
- 3) Schools. Rapid evacuations involving public and private schools, during school hours, present a special case as schools continue to be responsible for the children. Public school districts have prepared plans for evacuating school children using their own buses. However, if an evacuation is extremely urgent,

students will be evacuated by whatever means available and transported to a reception center, if possible. School officials are responsible for students even if they are not at their own facility.

- 4) Jail/Detention Centers. The evacuation plans for the County Jail are incorporated into their internal emergency operating procedures.
- 5) Nursing Home Facilities. Nursing homes have evacuation plans that are incorporated into their emergency operating procedures.
- 6) Special Needs. Since any registration of special needs populations is voluntary, those special needs populations that have been identified will be contacted and transportation support provided, as necessary.

3. Other Public Protection Strategies

- a. Relocation. Some HazMat incidents may contaminate the soil or water of an area posing a chronic threat to people living there. It may be necessary for people to move out of the area for a substantial period of time until the area is decontaminated or until natural weathering or decay reduces the hazard.
- b. Water Supply Protection. Surface and ground water supplies can be contaminated by a hazardous chemical release. Local public health officials must provide quick identification of a threat to the drinking water supply and expedient notification to the public. Officials should also notify the public of any alternate sources of drinking water and procedures for obtaining those alternate supplies.
- c. Sewage System Protection. A hazardous chemical entering the sewage system can cause serious and long-term damage to a treatment plant. It may be necessary to divert sewage, creating another public health threat and subsequent environmental problems.

M. Human Services

1. The various aspects of human services are coordinated by the EMA. Services on a small-scale can be provided by local volunteer organizations such as the Red Cross, Salvation Army, faith-based organizations, and those organizations responsible for eligibility programs. Another important resource for LaGrange County is their partnership in the IN211 agency, the *United Way of Allen County 211*, which can be reached by dialing 2-1-1 or 260-744-0700. In the event of large-scale support requirements, the EOC will request activation of State and Federal agencies.
2. The *LaGrange County CEMP, Human Support Section* identifies the role of human service agencies and their general procedures.

N. Health and Medical Services

1. A number of the functions associated with the County Board of Health may be performed by the Public Health Department's Environmental Health Officer.
2. The Environmental Health Officer shall respond to an incident at the request of the IC or a member of the EOC staff (if activated).
3. The County Board of Health's role includes the following:
 - a. Assistance in the assessment of an evolving hazard and initiation of contact with appropriate State agencies.
 - b. Testing or provision for testing of water, air, soil, or food where applicable.

- c. Providing a liaison with State and Federal agencies managing the HazMat containment.
- d. Providing advice and assistance with appropriate clean up procedures.
- e. Working with the EMA in overseeing public works and private contractor agencies as they implement procedures for the disposal of hazardous materials as directed by the EMA and/or IDEM.

O. Public Works

1. In the event of a HazMat incident, the appropriate street/highway department will be contacted to assist the IC or the EOC staff as needed. The public works agencies are responsible for the following activities:
 - a. Emergency debris removal and/or removal of debris to re-open roads and highways.
 - b. Construction of earthen dikes to contain spills or reroute them around critical areas such as water supplies and sewer inlets.
 - c. Road and bridge repairs.
 - d. Emergency assistance in maintaining service for critical facilities.
 - e. Barricade installation and rerouting of traffic.
 - f. Evacuation assistance.
2. The *LaGrange County CEMP, Infrastructure Section, ESF 3 - Public Works and Engineering* covers additional procedures for the deployment of public works personnel.

P. Resource Management

Mitigation procedures for problems caused by a HazMat incident may require additional resources from the public and private sectors. *LaGrange County CEMP Operations Section, ESF 7 - Resource Support* covers these procedures in general.

III. CONTAINMENT AND RESTORATION

A. Resources

1. The responsibility for selecting and implementing the appropriate countermeasures is assigned to the IC, in coordination with the EOC staff (when activated), and the appropriate technical assistance advisor.
2. By law the spiller is responsible for the costs of all clean up and countermeasures. The IC, together with appropriate State and Federal resources, is responsible for determining these measures, and monitoring the subsequent clean up and disposal of any contaminated materials. Federal and/or State resources have companies on contract to respond to HazMat incidents if the responsible parties are unknown, unwilling, or unable to respond correctly and promptly.
3. The IC should monitor the response activity to ensure that appropriate containment and control techniques are being initiated. Containment methods may include:
 - Dikes
 - Berms and drains
 - Trenches

- Booms
- Stream diversion
 - Patching and plugging of containers
 - Portable catch basins
 - Overpack drums or other containment instruments
 - Reorientation of the container

4. The spiller will secure private contractors for proper clean up and is responsible for advising the IC of any problems in these efforts.

B. Restoration

1. The LaGrange County EMA or LaGrange County Environmental Health Officer, in conjunction with State and Federal agencies, will participate in overseeing restoration efforts through its consequence management directives.
2. Treatment of contaminated soils and sediments is the responsibility of the spiller.
3. When feasible, contaminated soil and sediments may be treated on site. Technologies available include:
 - Incineration
 - Wet air oxidation
 - Solidification
 - Encapsulation
 - Solution mining (soil washing or soil flushing)
 - Neutralization/detoxification
 - Microbiological degradation
4. Transportation, storage, treatment, destruction, or disposition off site must be provided by the spiller in cases where local, State or Federal guidelines determine such actions.

IV. DOCUMENTATION AND INVESTIGATIVE FOLLOW UP

A. Level I HazMat Incident

1. In case of a Level I HazMat incident, the spiller must submit to the LEPC a brief description of the incident and the response rendered. Where the spill exceeded the reporting requirements the IC must ascertain that the spiller has notified the appropriate State and Federal agencies, as required.
2. The CEC, or her designee, will maintain a copy of all HazMat Incident Logs and report these incidents to the LaGrange County LEPC on a periodic basis.

B. Level II and Level III HazMat Incidents

1. The LEPC executive staff is responsible for ensuring a report is prepared and provided to the LEPC if the spill is regulated and over a reportable quantity. The report should summarize the entire incident, including:
 - a. Cause of the incident
 - b. Damage assessment
 - c. Agencies involved

- d. Actual cost of response activities (if known)
 - e. Incident critique
 - f. Conclusions
2. To assist with the completion of this report, the 911 Dispatch Center and the Incident Commander are responsible for documenting the communications between the ICP, the 911 dispatcher, and all response agencies involved. This documentation must include the location; the material and quantity of chemical released; the owner or operator involved; the source of spill; health or physical hazards generated; and response activities. For incidents occurring in a fixed facility, the owner or operator is required to submit a follow up report to the local LEPC, as well as the appropriate State and Federal agencies.
3. The LaGrange County EMA and/or individual agencies will consolidate all billings and assist the LEPC, as needed, in preparing the investigative report in order to facilitate any cost recovery. Any criminal investigations will be the responsibility of the LaGrange County Sheriff's Office.

V. TRAINING AND EXERCISES

A. Training

Training will be based upon the duties and functions to be performed by each responder of an emergency response organization. The skill and knowledge levels required for all new responders, those hired after the effective date of this Plan, shall be conveyed to them through training before they are permitted to take part in actual emergency operations of a HazMat incident. Responders who participate in a chemical emergency shall be given training in accordance with the following:

1. **First Responder – Awareness Level.** Responders at the awareness level are individuals who are likely to witness or discover a hazardous substance release and who have been trained to initiate an emergency response sequence by notifying the proper authorities of the release. They would take no further actions beyond notifying the LaGrange County 911 Dispatch Center of the release. First responders at the awareness level shall have sufficient training or had sufficient experience to objectively demonstrate competency in the following areas:
 - a. An understanding of what hazardous materials are, and the risks associated with them.
 - b. An understanding of the potential outcomes of an emergency where hazardous materials are present.
 - c. The ability to identify the hazardous materials, if possible.
 - d. An understanding of the role of the awareness level first responder in the department's Emergency Response Plan and the ERG.
 - e. The ability to recognize the need for additional resources.
2. **First Responder – Operations Level.** First responders at the operations level are individuals who respond to releases or potential releases of hazardous substances as part of the initial response to the site for the purpose of protecting nearby people, property, or the environment from the effects of the release. They are trained to respond in a defensive fashion without actually trying to stop the release. Their function is to contain the release from a safe distance, keep it from spreading, and prevent exposure. First

- responders at the operations level shall have received at least eight hours of additional training and be certified by the State of Indiana. They shall have had sufficient experience to objectively demonstrate competency in the following areas in addition to those listed for the awareness level. The responder's department shall certify responders trained at the operations level have:
- a. Knowledge of the basic hazard and risk assessment techniques.
 - b. The ability to select and use proper protective equipment provided to the first responder- operations level.
 - c. An understanding of the basic HazMat terms.
 - d. The ability to perform basic control, containment, and/or confinement operations within the capabilities of the resources and PPE available with their department.
 - e. The knowledge to implement basic decontamination procedures.
 - f. An understanding of the relevant SOPs.
3. **Incident Commander – ICS System.** Incident Commanders, who will assume control of the incident scene beyond the first responder-awareness level, shall receive training equal to the operations level. In addition, the responder's department shall certify competency in the following areas:
- a. Know and be able to implement the department's ICS system in accordance with NIMS.
 - b. Know and be able to implement the department's SOPs for HazMat incidents.
 - c. Know and understand the hazards and the risks associated with responders working in chemical protective clothing.
 - d. Know and understand the importance of decontamination procedures.
4. **Refresher Training.** Those responders who are trained in accordance with 29-CFR 1910.120 shall receive annual refresher training of sufficient content and duration to maintain their competency, and if a statement of competency is made, the appropriate department shall maintain a record of the methodology used to demonstrate the competency. Appendix 8 shows training schedule.

B. Exercises

The LaGrange County EMA Director is currently responsible for designing, scheduling, and evaluating LEPC exercises and drills. All signatory agencies shall participate in periodic HazMat drills and exercises. At least one annual HazMat exercise (tabletop, functional, or full-scale) shall be conducted in accordance with IERC annual guidelines. Each exercise shall be followed by a critique to review the effectiveness of this Plan and its support systems. This Plan may be revised on the basis of these exercise critiques.

VI. ANNEX MAINTENANCE

The LaGrange County LEPC, with the support of the county's Chief Executives and the EMA Director, is responsible for the review and update of this *Hazardous Materials Emergency Response Plan*. This plan shall be updated at least annually under the direction of the LEPC. Appendices of this Plan may be updated more frequently.

VII. AUTHORITIES AND REFERENCES

A. Authorities

40 CFR Part 301, Reimbursement to Local Governments for Emergency Response to Hazardous Substance Releases

40 CFR Part 302, Comprehensive Environmental Response Compensation and Liability Act (CERCLA) List of 717 Substances

40 CFR Part 310, Reimbursement to Local Governments for Emergency Response to Hazardous Substance Releases, Interim Final Rule

40 CFR Part 355 and Appendix A, List of 406 Extremely Hazardous Substances

40 CFR Part 370, Hazardous Chemical Reporting: Community Right to Know, Tier I and Tier II Forms, Chemical Inventory Reporting

40 CFR Part 372, Toxic Chemical List, Toxic Chemical Release Reporting: Community Right to Know

CERCLA of 1980 (Public Law 96-510)

LaGrange County Emergency Management Ordinance

Emergency Management and Assistance (44 US Code 2.1)

Governor's Executive Order 05-09

Indiana Code Title 10-14-3-17

Local Mutual Aid Agreements

Title III, Federal Emergency Planning and Community Right to Know of the Superfund Amendments and Reauthorization Act (SARA) of 1986 (Public Law 99.499)

B. References

FEMA Hazardous Materials Contingency Planning Course

Hazardous Materials Exercise Evaluation Methodology (HM-EEM)

Homeland Security Exercise and Evaluation Program (HSEEP)

National Response Team Hazardous Materials Emergency Response Planning Guide

Technical Guidance for Hazardous Analysis Emergency Planning for Extremely Hazardous Substances

United States Department of Transportation (DOT) Emergency Response Guidebook (ERG)

VIII. ACRONYMS AND ABBREVIATIONS

| Acronym | Terminology |
|---------|---|
| CAS | Chemical Abstracts Service (division of American Chemical Society) |
| CEC | Community Emergency Coordinator |
| CEMP | Comprehensive Emergency Management Plan |
| CERCLA | Comprehensive Environmental Response, Compensation, and Liability Act |
| CFR | Code of Federal Regulations |

LaGrange County Local Emergency Planning Committee
Hazardous Materials Emergency Response Plan

| Acronym | Terminology |
|----------|--|
| CSEPP | Chemical Stockpile Emergency Preparedness Program |
| DFBS | Department of Fire and Building Services |
| DOT | Department of Transportation |
| EAS | Emergency Alert System (formerly the Emergency Broadcast System) |
| EHS | Extremely Hazardous Substance |
| EMA | Emergency Management Agency |
| EMAC | Emergency Management Assistance Compact |
| EMS | Emergency Medical Service |
| EOC | Emergency Operations Center |
| EOD | Explosive Ordnance Disposal |
| EOP | Emergency Operations Plan |
| EPA | U.S. Environmental Protection Agency |
| EPCRA | Emergency Planning and Community Right-to-Know Act |
| EPI | Emergency Public Information |
| ERG | Emergency Response Guidebook |
| ESF | Emergency Support Function |
| FBI | Federal Bureau of Investigation |
| FCO | Federal Coordinating Officer |
| FEC | Facility Emergency Coordinator |
| FEMA | Federal Emergency Management Agency |
| GIS | Geographic Information System |
| HAZMAT | Hazardous Materials |
| HAZWOPER | Hazardous Waste Operations and Emergency Response |
| HM-EEM | Hazardous Materials Exercise Evaluation Program |
| HSEEP | Homeland Security Exercise and Evaluation Program |
| HSPD | Homeland Security Presidential Directive |
| IAP | Incident Action Plan |
| IC | Incident Commander |
| ICP | Incident Command Post |
| ICS | Incident Command System |
| IDEM | Indiana Department of Environmental Management |
| IDHS | Indiana Department of Homeland Security |
| IERC | Indiana Emergency Response Commission |
| LCEMA | LaGrange County Emergency Management Agency |
| LCLEPC | LaGrange County Local Emergency Planning Committee |
| LEPC | Local Emergency Planning Committee |
| MOA | Memorandum of Agreement |
| MOU | Memorandum of Understanding |
| MSDS | Material Safety Data Sheet |
| NFPA | National Fire Protection Association |
| NIMS | National Incident Management System |
| NIOSH | National Institute for Occupational Safety and Health |
| NRC | National Response Center/Nuclear Regulatory Commission |
| NRF | National Response Framework |
| NRP | National Response Plan |
| NRT-1 | National Response Team |

| Acronym | Terminology |
|---------|--|
| NWS | National Weather Service |
| OSC | On-Scene Coordinator |
| OSHA | Occupational Safety and Health Administration |
| PIO | Public Information Officer |
| POC | Point of Contact |
| PPE | Personal Protective Equipment |
| PRP | Potentially Responsible Party |
| SARA | Superfund Amendments and Reauthorization Act of 1986 (EPCRA) |
| SERC | State Emergency Response Committee |
| SCBA | Self-Contained Breathing Apparatus |
| SOG | Standard Operating Guideline |
| SOP | Standard Operating Procedure |
| UAC | Unified Area Command |
| UC | Unified Command |
| UCS | Unified Command System |

IX. GLOSSARY OF TERMS/DEFINITIONS

Chemical Emergency Stockpile Emergency Preparedness Program (CSEPP) – A program developed by the EPA to address accidental releases of acutely toxic chemicals.

Community Emergency Coordinator (CEC) - Governmental official with the responsibility of making the determinations necessary to implement county *Hazardous Materials Emergency Response Plans*. This person is usually the Emergency Management Agency Director.

Comprehensive Emergency Management Plan (CEMP) - The “steady-state” plan maintained by various jurisdictional levels for responding to a wide variety of potential hazards.

Comprehensive Environmental Response, Compensation, and Liability Act (CERCLA) – A law regarding hazardous substance releases into the environment and the clean up of inactive hazardous waste disposal sites (i.e., Superfund sites).

Consequence Management - Measures to alleviate the damage, loss, hardship, or suffering caused by emergencies. It includes measures to restore essential government service, protect public health and safety, and provide emergency relief to affected governments, businesses, and individuals. Federal agencies will provide support local response efforts under the coordination of the FEMA.

Crisis Management - Measures to resolve the hostile situation, investigate, and prepare a criminal case for prosecution under federal law. Crisis management response is under the primary jurisdiction of the federal government with the FBI acting as the lead agency.

Critical Facilities - Facilities essential to emergency response, such as fire stations, police stations, hospitals, and communications centers.

Decontamination - The process of making any person, object, or area safe by absorbing, destroying, neutralizing, making harmless, or removing the hazardous material.

Emergency Alert System (EAS) - Formerly the Emergency Broadcasting System (EBS) the EAS is used to inform the public about the nature of an emergency incident and what safety steps they should take.

Emergency - A situation which poses a threat to the safety of workers, residents, the environment, and/or property.

Emergency Operations Center (EOC) - The physical location at which the coordination of information and resources to support domestic incident management activities normally takes place. An EOC may be a temporary facility or may be located in a more central or permanently established facility, perhaps at a higher level of organization within a jurisdiction. Emergency Operations Centers may be organized by major functional disciplines (e.g. fire, law enforcement, and medical services); by jurisdiction (e.g., Federal, State, regional, county, city, or tribal); or some combination thereof.

Emergency Planning and Community Right-to-Know Act (EPCRA) - Title III of the Superfund Amendments and Reauthorization Act of 1986, 42 U.S.C. s. 11001, et seq which is often referred to as SARA Title III. The Emergency Planning and Community Right-to-Know Act specifies requirements for organizing the planning process at the State and local levels; minimum plan content; requirements for fixed facility owners and operators to inform officials about extremely hazardous substances present at facilities; and mechanisms for making information about these substances available to citizens. Facilities that use, produce, or store extremely hazardous substances or hazardous chemicals may fall under the reporting requirements of EPCRA. Facilities must report their chemical inventories if those inventories meet or exceed the listed threshold planning quantity for an EHS or if 10,000 pounds of a hazardous chemical that requires the facility to maintain a Material Safety Data Sheet (MSDS) is present.

Exclusion Zone - The area that immediately surrounds a hazardous material or a nuclear, chemical, or biological release or spill. This is the innermost of the three HazMat control zones, and is also known as the hot zone.

Exercise - A simulated accident or release set up to test emergency response methods and for use as a training tool.

Extremely Hazardous Substance (EHS) - Those chemicals identified by the US EPA on the basis of toxicity and listed under EPCRA, Section 302.

Facility - Defined in Section 302 of EPCRA as all property (e.g., field or grove), buildings, equipment, structures, and other stationary items which are located on a single site or on contiguous or adjacent sites and which are owned or operated by the same person (or by any person that controls, is controlled by, or under common control of such person) and where the threshold planning quantity is met for one or more extremely hazardous substances. For purposes of emergency release notification, the term facility includes motor vehicles, transported loads, and aircraft.

Hazardous Material (HazMat) - Any substance or material in a quantity or form which may be harmful to humans, animals, crops, water systems, or other elements of the environment if accidentally released. Hazardous materials include: explosives, petroleum, gases (compressed, liquefied, or dissolved), flammable and combustible liquids, flammable solids or substances, oxidizing substances, poisonous and infectious substances, radioactive materials, and corrosives.

Hot Zone - An area where hazardous vapors and liquids are present. This area is considered to be dangerous due to biological, chemical, or nuclear contamination. Individuals must be trained and prepared to enter and leave the area through specific corridors. This is also known as the exclusion zone.

Incident Commander (IC) - The pre-designated local, State, or Federal official responsible for the coordination of hazardous materials response actions, as outlined in the pertinent emergency response plan.

Incident Command Post (ICP) - Facility located at a safe distance upwind from an accident site, where the on scene commander, responders, and technical representatives can make response decisions, deploy manpower and equipment, maintain liaison with the media, and handle communications.

Incident Command System (ICS) - The combination of facilities, equipment, personnel, procedures, and communications operating within a common organizational structure and having the responsibility for management of assigned resources to effectively accomplish stated objectives at the scene of an incident as mandated by OSHA.

Level A Protection - The highest available level of respiratory, skin, splash, and eye protection which requires fully encapsulating vapor protective clothing with supplied breathing air. Level A HazMat releases have a high vapor pressure and is toxic through skin absorption or is carcinogenic.

Level B Protection - The level of protective equipment utilized where the environment is not considered acutely vapor toxic to skin but may cause respiratory effects. In such situations a chemical splash suit or full coverage, non-air tight, chemical suit with self contained breathing apparatus (SCBA) or supplied air breathing apparatus (SABA) is required.

Level C Protection - The level of protective equipment required to prevent respiratory exposure but does not include protection of skin contact (i.e., full -face air purifying respirator, inner and outer chemical-resistant gloves, hard hat, escape mask, and disposable chemical-resistant out boots).

Level D Protection - The level of protective equipment required when the atmosphere contains no known hazard, when splashes, immersions, inhalation, or contact with hazardous levels of any chemical is precluded. Work uniform such as coveralls, boots, leather gloves, and hard hat are used for such situations.

National Incident Management System (NIMS) - The system mandated by the Homeland Security Presidential Directive (HSPD)-5 that provides a consistent nationwide approach for Federal, State, local, and tribal governments; the private-sector, and nongovernmental organizations to work effectively and efficiently together to prepare for, respond to, and recover from domestic incidents, regardless of cause, size, or complexity. To provide for interoperability and compatibility among Federal, State, local and tribal capabilities, the NIMS includes a core set of concepts, principles, and terminology. Homeland Security Presidential Directive-5 identifies these items as the ICS, multi-agency coordination systems; training; identification and management of resources (including systems for classifying types of resources); qualification and certification; and the collection, tracking, and reporting of incident information and incident resources.

National Response Framework (NRF) The purpose of the NRF is to establish a comprehensive, natural, all -hazards approach to domestic incident response by establishing an overview of key response principles, roles, and structures to guide the national response. Designed as a follow -on to the initial National Response Plan, which was actually a “framework” written to guide the integration of State, tribal, and Federal response efforts. Adopting the word “framework” within the title now actually aligns the former NRP document with its intended purpose. It has been written for senior elected and appointed leaders at all levels of government - those who have a responsibility to provide for effective incident management. At the same time, it is designed to inform emergency management practitioners, explaining the operating structures and tools used routinely by first responders and emergency managers at all levels of government.

National Response Plan (NRP) - The former plan mandated by HSPD-5 that integrated Federal domestic prevention, preparedness, response, and recovery plans into an all-discipline, all-hazard plan. Plan was replaced in 2009 by the National Response Framework.

Risk - A measure of the probability that damage to life, property, and/or the environment will occur if a hazard manifests itself; this measure includes the severity of anticipated consequences to people.

Risk Analysis - Assessment of the probable damage that may be caused to the community by a hazardous substance release.

Special Populations - Groups of people that may be more susceptible than the general population (due to preexisting health conditions [e.g., asthmatics] or age [e.g., infants and the elderly]) to the toxic effects of an accidental release.

Unified Area Command (UAC) - An organization established (1) to oversee the management of multiple incidents that are each being handled by an ICS organization or (2) to oversee the management of a large-scale incident or multiple incidents to which several Incident Management Teams have been assigned. The Area Command has the responsibility to set overall strategy and priorities, allocate critical resources according to priorities, ensure that incidents are properly managed, and ensure that objectives are met and strategies followed. Area Command becomes Unified Area Command when incidents are multi-jurisdictional. Area Command may be established at an EOC facility or at some location other than an ICP.

Unified Command (UC) - An application of ICS used when there is more than one agency with incident jurisdiction or when incidents cross political jurisdictions. Agencies work together through the designated members of the UC, often the senior person from each agency and/or discipline will participate in the UC, to establish a common set of objectives and strategies and a single Incident Action Plan (IAP).

Vulnerability Analysis (VA) - Assessment of elements in the community that are subject to damage should a hazardous materials release occur; includes gathering information on the extent of the vulnerable zone; conditions that influence the zone; size and type of the population within the zone; private and public property that might be damaged; and the environment that might be affected.

X. APPENDICES

- 1 - LaGrange County Primary Response Agencies/HazMat Responders
- 2 - Police, Fire, and Ambulance Locations
- 3 - Pipeline, Railroad, and Transportation Routes
- 4 - EHS Fixed Facility Vulnerability Zones and Evacuation Routes
- 5 - EHS Fixed Facilities Information and Facility Emergency Coordinators (FECs)
- 6 - Non-EHS Fixed Facility Vulnerability Zones and Evacuation Routes
- 7 - Non-EHS Fixed Facility Information and Facility Emergency Coordinators (FECs)
- 8 - Training and Exercise Program/Schedule
- 9 - Media Contacts
- 10 - Population Protection Information (Shelter-in-Place and Evacuation)
- 11 - Exercise Evaluation Forms/Checklists
- 12 - Public Address Announcement Samples
- 13 - LaGrange County LEPC Membership Roster
- 14 - County/City/Township Contact Numbers
- 15 - Chemical Emergency Notification Report
- 16 - Resource List
- 17 - Hazardous Material Decision Event Trees

APPENDIX I - LAGRANGE COUNTY PRIMARY RESPONSE AGENCIES/HAZMAT RESPONDERS

LaGrange County does not have a HazMat team trained for protective measures and decontamination responsibility to respond to hazardous material incidents throughout the county. If a Hazmat Response Team is needed, LaGrange County personnel rely initially on the Kendallville Fire Department (Noble County) or Angola Fire Department (Steuben County) for primary assistance.

LaGrange County Local Emergency Planning Committee
Hazardous Materials Emergency Response Plan

| HAZMAT TEAM | |
|--|--|
| <u>Noble County Hazmat Team</u> Kendallville Fire Department <u>Fire Station #1</u> 307 Drake Road 260-347-1252 or 911 Hazmat Incident Command Trailer <u>Fire Station #2</u> 304 E North Street 260-347-5010 or 911 Hazmat Equipment Semi Trailer- (Unit #113) | <u>Steuben County Hazmat Team</u> Angola Fire Department 202 W Gilmore Street Angola IN 46703 260-665-5555 In an emergency, contact through the Steuben County 911 Dispatch Center at 260-665-3131 |

| CONTRACT CLEAN-UP RESPONDERS | |
|---|---|
| Capitol Environmental Enterprises 2244 Profit Dr Indianapolis, IN 46241 317-240-8085 Fax: 317-241-4180 | ERS, Inc (Environmental Remediation Svcs) 4010 Option Pass Fort Wayne, IN 46818 260-489-7062 Fax: 260-489-5752 |
| ERS, Inc (Environmental Remediation Svcs) 8450 W Washington St Indianapolis, IN 46231 317-247-6119 Fax: 317-247-6126 | Heritage Environmental Services, LLC 7901 W Morris St Indianapolis, IN 46231 317-243-0811 1-800-436-8778 Fax: 317-486-5085 |
| Specialty Systems Hazardous Waste, Inc. 310 South State Avenue Indianapolis, IN 47201 317-269-3626 317-269-2101 (24-hour) | Summit Contracting, LLC 5601 Progress Road Indianapolis, IN 46241 317-284-0377 1-877-421-1744 (24-hour) Fax: 317-284-0380 |

- FOR OFFICIAL USE ONLY-

Sensitive Information - contains personal cellular telephone numbers

APPENDIX 2 - POLICE, AMBULANCE, AND FIRE LOCATIONS

LaGrange County Local Emergency Planning Committee
Hazardous Materials Emergency Response Plan

| COUNTY LAW ENFORCEMENT OFFICES | |
|--|---|
| 1-LaGrange County Sheriff 0875 S State Road 9 LaGrange IN 260-463-7491 Sheriff: Jeff Campos 260-367-1230 (cell) | 2-LaGrange Police Department 1201 North Townline Road LaGrange IN 260-463-7031 Chief: Rich Snyder 260-499-0788 (cell) |
| 3- Shipshewana Police Department 345 North Morton Street Shipshewana IN 260-768-4310 Chief: Tom Fitch 260-336-0130 (cell) | 4-Topeka Police Department 101 S. Main Street Topeka IN 260-593-2822 Marshal: Stan Strater 260-463-6288 (cell) |
| 5-Wolcottville Police Department 104 Race Street Medical Training: Wolcottville IN 1 EMT 260-854-2930 Chief: Nate Sprunger 260-993-2490 (cell) | |

| AMBULANCE LOCATIONS | |
|---|---|
| 1-Parkview-LaGrange EMS 0982N – 00EW LaGrange IN 46761 260-463-9000 Logan Ison 574-527-8954 (c) Jeff Helmuth 260-350-2415 (c) 3 Ambulances 21 Paramedics/10 Intermediate | 2-Additional ambulances are stationed at: (a) West side station 8175 W US 20 Shipshewana, IN |

- FOR OFFICIAL USE ONLY-

Sensitive Information - contains personal cellular telephone numbers

Fire Department Contacts

| Department | Fire Chief | Phone Number | Email |
|-------------------|-------------------|---------------------|----------------------------|
| LaGrange | Jeremy Edwards | 260-463-1025 | inknshooter@yahoo.com |
| Shipshewana | Chad Miller | 260-499-0132 | tiger3sk@embarqmail.com |
| Topeka | Stewart Bender | 260-350-2323 | firechief@topeka-in.gov |
| Howe | Larry Watson | 260-350-3407 | howefirechief401@gmail.com |
| Johnson Township | Joe Billman | 260-463-1665 | joe@kuntrynet.com |
| Mongo | Josh Watts | 260-577-0752 | mongofirechief@gmail.com |
| Stroh | Tyler Terry | 260-585-7229 | tylerterry72@gmail.com |

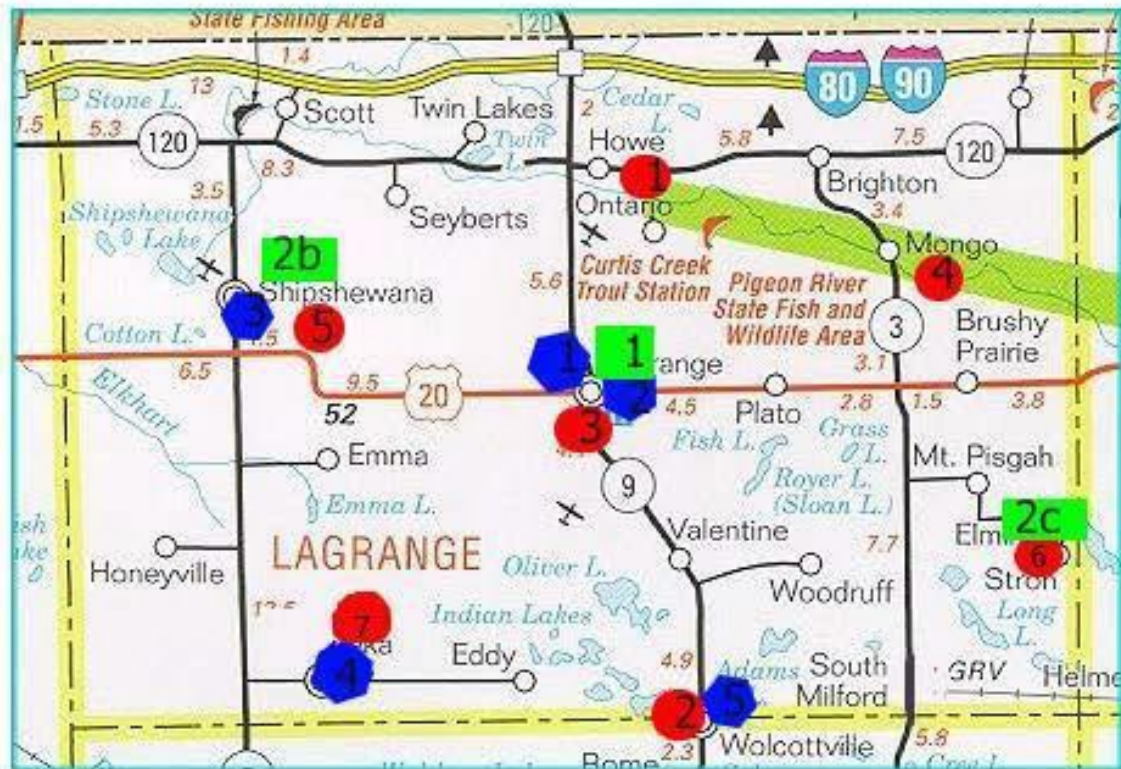

Police- Ambulance- Fire Department Locations in County

LaGrange County Local Emergency Planning Committee
Hazardous Materials Emergency Response Plan

**NOTE: THIS MAP IS CONSIDERED SENSITIVE BY HOMELAND SECURITY
& FOR OFFICIAL USE ONLY**



**NOTE: THIS MAP IS CONSIDERED SENSITIVE BY HOMELAND SECURITY
& FOR OFFICIAL USE ONLY**

ANR Pipeline Company



LaGrange County Local Emergency Planning Committee
Hazardous Materials Emergency Response Plan

| RAILROADS | |
|---|--|
| Indiana Northeastern Railroad Company (formerly Pigeon River Railroad Co.) 7570 S-790 E South Milford IN 46786 260-351-2421 In an emergency, contact Gayle Schultz 260-367-1717 (cell) | |

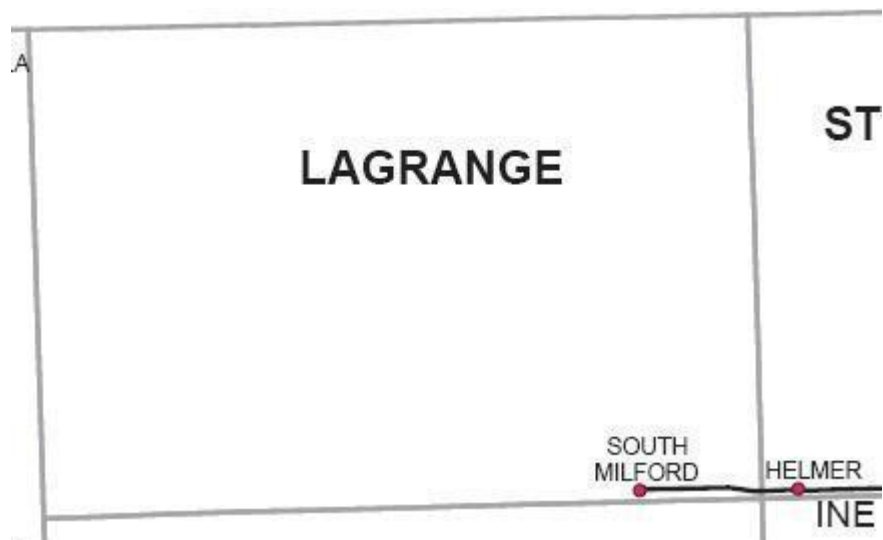

| ROADWAYS | |
|---------------------------------|-----------------|
| Interstate 80/90 (Toll Road) | US Highway 20 |
| | State Route 3 |
| | State Route 5 |
| | State Route 9 |
| | State Route 120 |



FOR OFFICIAL USE ONLY-

Sensitive Information - Tabs 4 & 5 may contain personal cellular telephone numbers...

**APPENDIX 4 - EHS FIXED FACILITY VULNERABILITY ZONES AND
EVACUATION ROUTE**

AT&T COMMUNICATIONS

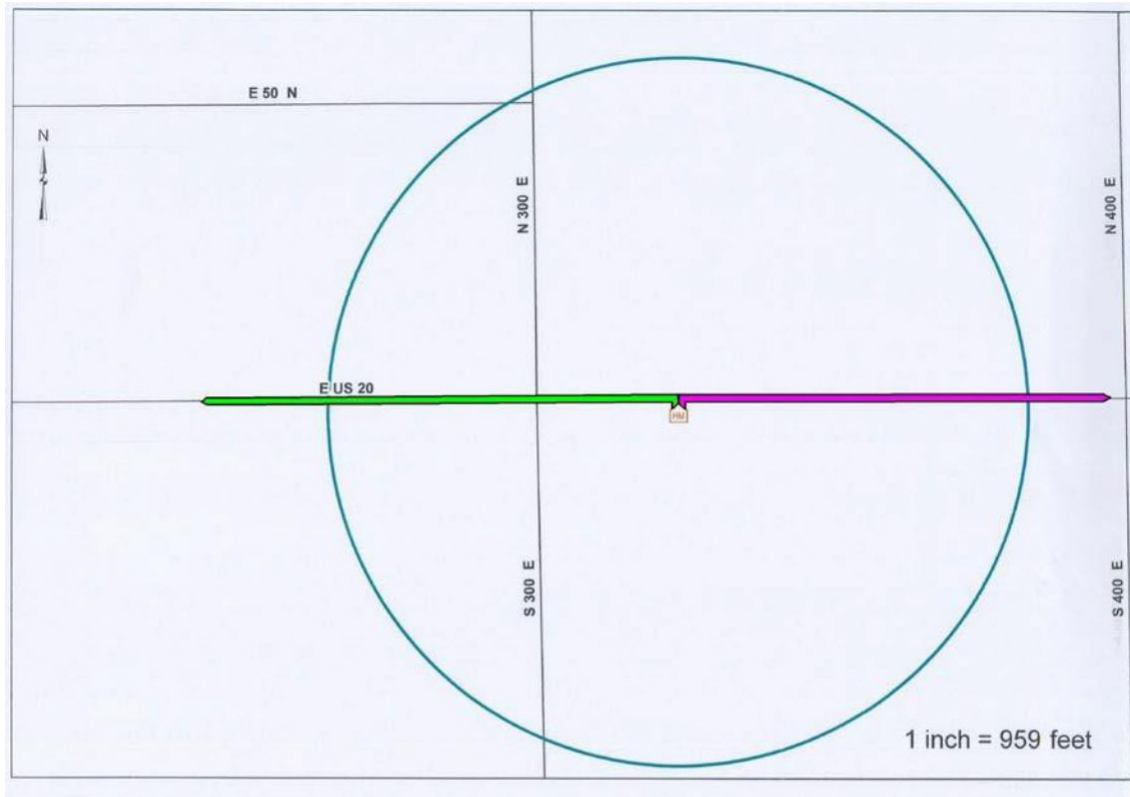

- Suggested Primary Evacuation Route
- Suggested Secondary Evacuation Route
- 3168' Maximum Vulnerability Area for Sulfuric Acid (batteries)
- 19 Potential Households Affected by the MVA

POTENTIAL AGENCIES TO BE EVACUATED
NONE

HUBBARD MILLING COMPANY

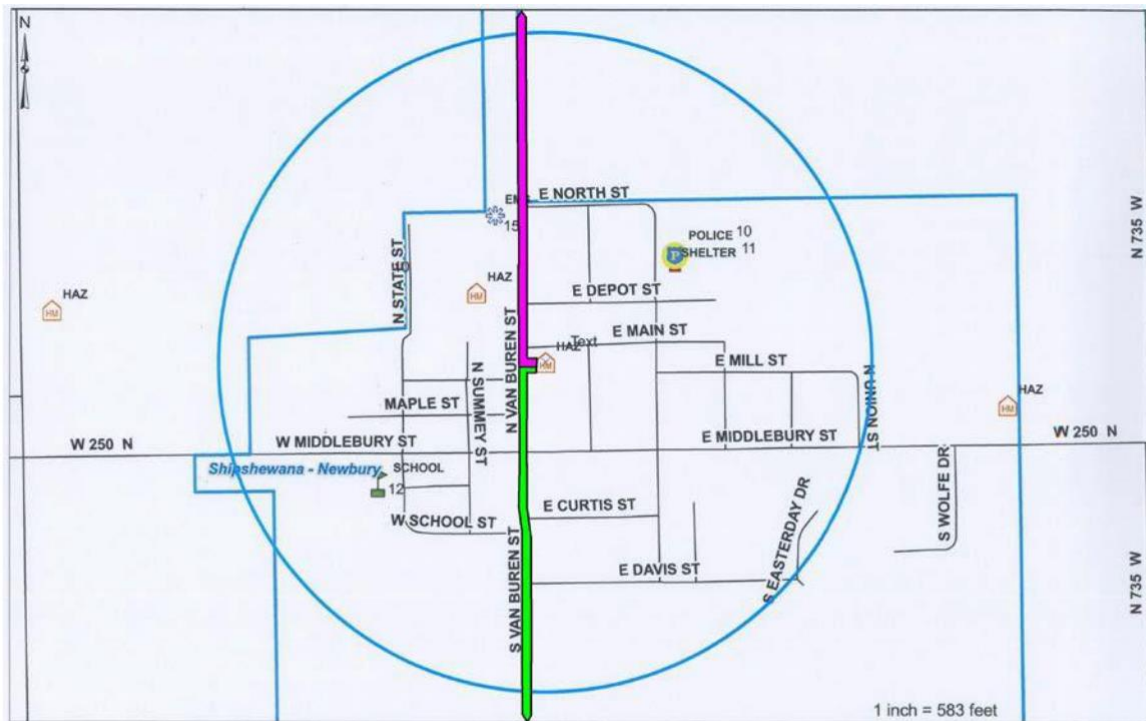

- Suggested Primary Evacuation Route
- Suggested Secondary Evacuation Route
- 1742' Maximum Vulnerability Area for Sodium Selenate/Cobalt Carbonyl
- 254 Potential Households Affected by the MVA

POTENTIAL AGENCIES TO BE EVACUATED

Emergency Services

| | | |
|--------------------|-----------------|-------------|
| Shipshewana Police | 345 Morton | Shipshewana |
| EMS | 460 N. VanBuren | Shipshewana |

Public Schools



| | | |
|------------------------------|----------------|-------------|
| Shipshewana Scott Elementary | 325 Middlebury | Shipshewana |
|------------------------------|----------------|-------------|

Shelters

| | | |
|----------------|------------|-------------|
| Wolfe Building | 345 Morton | Shipshewana |
|----------------|------------|-------------|

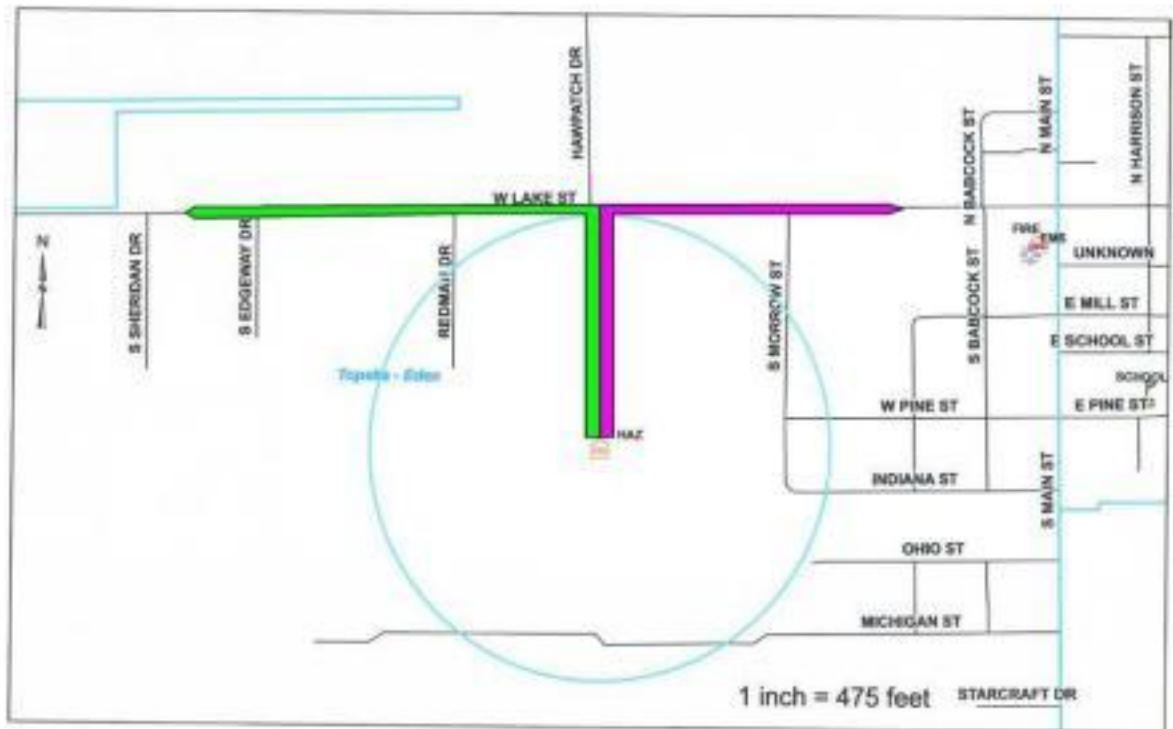
NISHIKAWA STANDARD COMPANY





-  Suggested Primary Evacuation Route
 Suggested Secondary Evacuation Route
1000' Maximum Vulnerability Area for Sulfuric Acid (batteries)
52 Potential Households Affected by the MVA

POTENTIAL AGENCIES TO BE EVACUATED
NONE

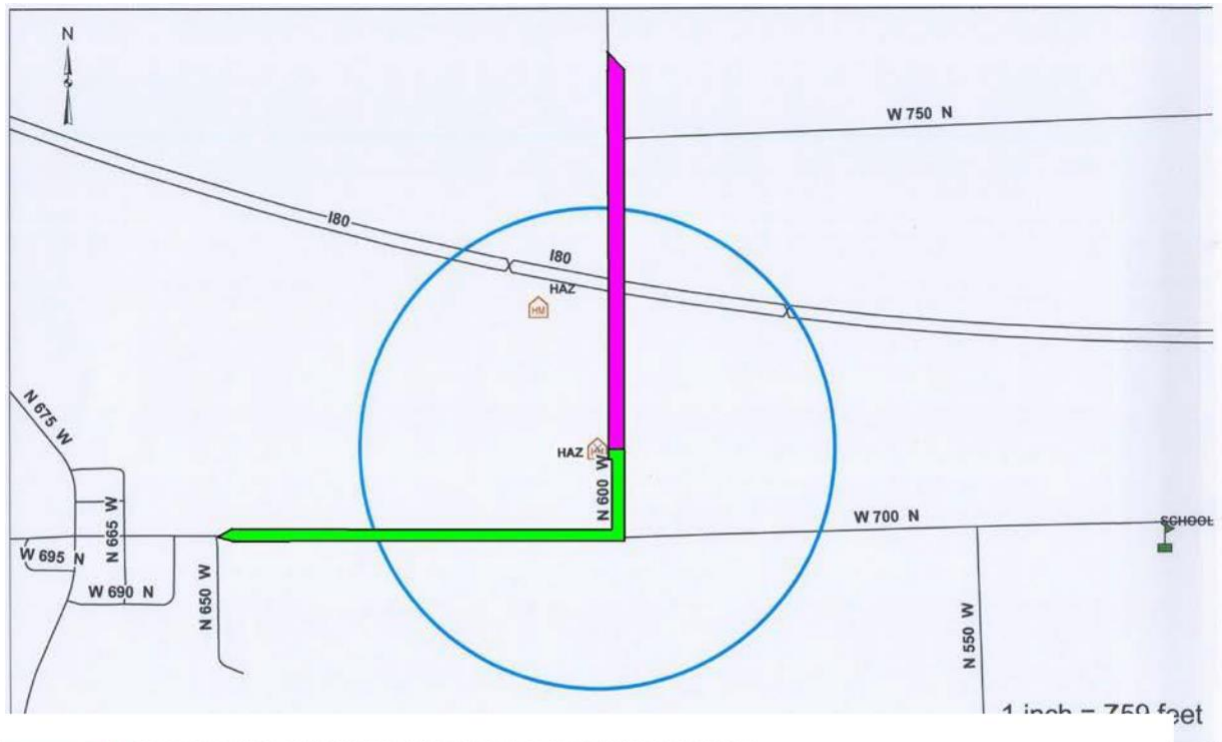
N&M, INC.



-  Suggested Primary Evacuation Route
-  Suggested Secondary Evacuation Route
- 1584' Maximum Vulnerability Area for Ammonia/Hydrogen Sulfide
- 7 Potential Households Affected by the MVA

POTENTIAL AGENCIES TO BE EVACUATED
NONE

SHIPSHEWANA IN WCG (aka: Level 3 Communications)

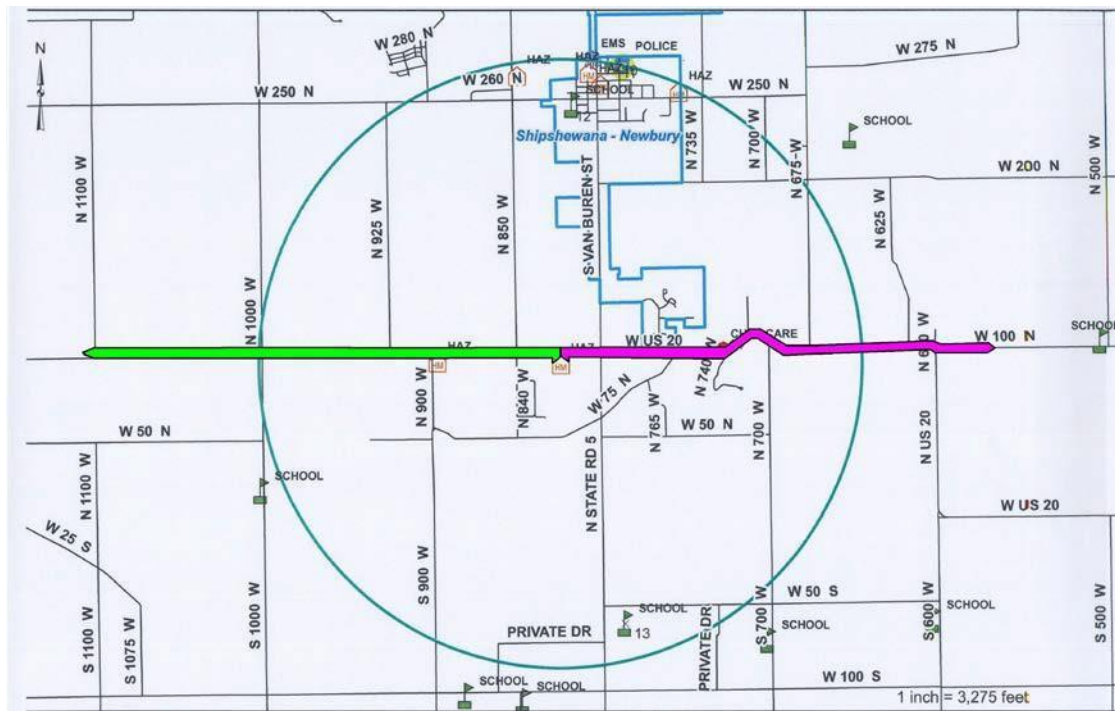

- Suggested Primary Evacuation Route
- Suggested Secondary Evacuation Route
- 9504' Maximum Vulnerability Area for Sulfuric Acid (batteries)
- 722 Potential Households Affected by the MVA

POTENTIAL AGENCIES TO BE EVACUATED

Emergency Services

| | | |
|--------------------|------------|-------------|
| Shipshewana Police | 345 Morton | Shipshewana |
|--------------------|------------|-------------|

Public Schools

| | | |
|------------------------------|--------------------|-------------|
| Meadowview Elementary School | 7950 W 50 S | Shipshewana |
| Shipshewana Scott Elementary | 325 Middlebury St. | Shipshewana |

Day Cares

| | | |
|---------------------------------|--------------|-------------|
| Rainbow Years Learning Ministry | 7235 W US 20 | Shipshewana |
|---------------------------------|--------------|-------------|

Shelters

| | | |
|----------------|------------|-------------|
| Wolfe Building | 345 Morton | Shipshewana |
|----------------|------------|-------------|

LaGrange County Local Emergency Planning Committee
Hazardous Materials Emergency Response Plan

APPENDIX 5 - EHS FIXED FACILITIES INFORMATION AND FACILITY EMERGENCY COORDINATORS (FECs)

| FACILITY | LAT/LONG | EMERGENCY CONTACTS | PLAN LOCATION | ALARM | EQUIPMENT | TRAINING |
|--|---------------------------|--|--|-------|------------|--|
| AT & T Communications 60 E Central Avenue (now: 3230E – US20) LaGrange IN | N41-38.494 W085-21.819 | Jeremy McGrue 214-464-1712 Brett Lunsford 765-686-7049 Hotline 800-566-9347 | Central Office | None | Absorbents | Company Training |
| Central Office – Remote EMBARQ 117 S Poplar Street LaGrange IN 46761 Did Not Report | N41-38.589 W085-24.998 | David Burk 660-429-155 866-864-2251 Operations Center 877-877-7758 | Office | None | Absorbents | Company Training |
| Edd's Supplies 2665N – 850W Shipshewana IN 46565 | N41-40.697 W085-35.379 | Jim Young 260-350-0486 Jeff Osborn 260-350-0495 | None | None | Spill kits | Company Training |
| Hubbard Milling Company 135 Main Street Shipshewana IN 46565 | N41-40.667 W085-34.814 | Jim Long 574-527-6250 Jimmy Sexton 859-885-9613 | Bulletin board | None | Spill kits | Company Training |
| Therma Tru 8055 N SR 9 Howe, IN 46746 | N41-758843 W-85.427045 | Cary Myer 517-932-8313 Rick Goodman 260-615-2240 Steve Ambrose 260-645-1233 | Office | None | Spill Kit | Company Training |
| Nishikawa Standard Company 324 Morrow Street Topeka IN | N41-32.167 W085-32.795 | Michael Hough 260-571-5287 Brad Keller 574-216-0707 | Safety Manager & HR Manager's offices | None | Spill kits | Company Training 9 First Responders |

LaGrange County Local Emergency Planning Committee
Hazardous Materials Emergency Response Plan

| FACILITY | LAT/LONG | EMERGENCY CONTACTS | PLAN LOCATION | ALARM | EQUIPMENT | TRAINING |
|--|------------------------------|--|-----------------|----------------|--|---|
| N & M, Inc. 7100N – 600W LaGrange IN 46761 Did Not Report | N41-44.609 W085-32.642 | William Nofziger 419-852-8037 Jennifer Nofziger 269-625-7140 | Unknown | None | None | Company Training |
| Centurylink (Level 3 Communications) 8210W – US 20 Shipshewana IN 46565 | 41.65459,-85.58507 | Danielle Mateyka 720-888-1950 866-864-2255 | Central Office | None | None | Company Training |
| United Telephone Company Indiana DBA CenturyLink Lagrange Central Office 117 South Poplar Street, Lagrange, IN 46761 | 41.6437009,- 85.41660704 | Danielle Mateyka 720-888-1950 866-864-2255 | Unknown | Unknown | Unknown | Unknown |
| United Telephone Company Indiana DBA CenturyLink Shipshewana Central Office 250 North Vanburen Street, Shipshewana, IN 46565 | 41.67756714,- 85.58071397 | Danielle Mateyka 720-888-1950 866-864-2255 | Unknown | Unknown | Unknown | Unknown |
| Dometic Corp 509 S. Poplar St., LaGrange, IN 46761 | 41.6392,-85.4162 | Tom Christophel 574-596-1073 Paul Slipetz 260-479-0934 Duane Hobbs 260-336-2293 | digital | Yes-fire | Spill kits and absorbents | Company training |
| Exo-s 6505 north state road 9, howe, IN 46746, United States | 41.73587,-85.42565 | Matt Christian 269-506-3444 | In digital form | Fire & weather | Spill kits, absorbent, pads, socks | GHS training. first responders on site |
| K-Z Inc. 9270 W. US HWY. 20, Shipshewana, IN 46565, United States | 41.653926,- 85.605194 | Delbert Miller 574-825-2720 Jerry Pittenger 574-536-6822 | Unknown | Unknown | Unknown | Unknown |

LaGrange County Local Emergency Planning Committee
Hazardous Materials Emergency Response Plan

| | | | | | | |
|--|--------------------------|--|--|--|--|--|
| Lund International, Inc. 7225 N SR 9, Howe, IN 46746, United States | 41.748128,- 85.426778 | Diana Elkins 269-625-2369 Gil Catlette 404-353-0284 Dean Mettler 260-499-1275 Harlan Bontrager 269-625-2369 | In the office and throughout the plant | Yes | Spill kits throughout the plant. | Company training and first responders on site |
| Middlebury Cheese Company 11275 W 250 N, Middlebury, IN 46540, United States | 41.666711,- 85.644424 | Bela Sandor 574-536-0260 | TBD | Yes- wastewater treatment plant, boilers | spill kit | Pending |
| Town of Topeka Water Treatment Plant 226 N Pleasant, Topeka, IN 4657 | 41.5412,-85.5354 | Stewart Bender 260-350-2323 Tom Sheline 260-463-1095 | N/A | Chlorine leak detection | none | Local FD |
| | | | | | | |
| | | | | | | |
| | | | | | | |



- FOR OFFICIAL USE ONLY -

Sensitive Information - Tabs 6 & 7 may contain personal cellular telephone numbers...

**APPENDIX 6 – NON-EHS FIXED FACILITY VULNERABILITY ZONES
AND EVACUATION ROUTES**

FAA-QTZ ARSR

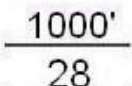

-  Suggested Primary Evacuation Route
-  Suggested Secondary Evacuation Route
-  1000'
28 Maximum Vulnerability Area for Fuel Oil
Potential Households Affected by the MVA

POTENTIAL AGENCIES TO BE EVACUATED

Emergency Services

LaGrange County Police

0875 S. St. Rd. 9

LaGrange

FERRELLGAS

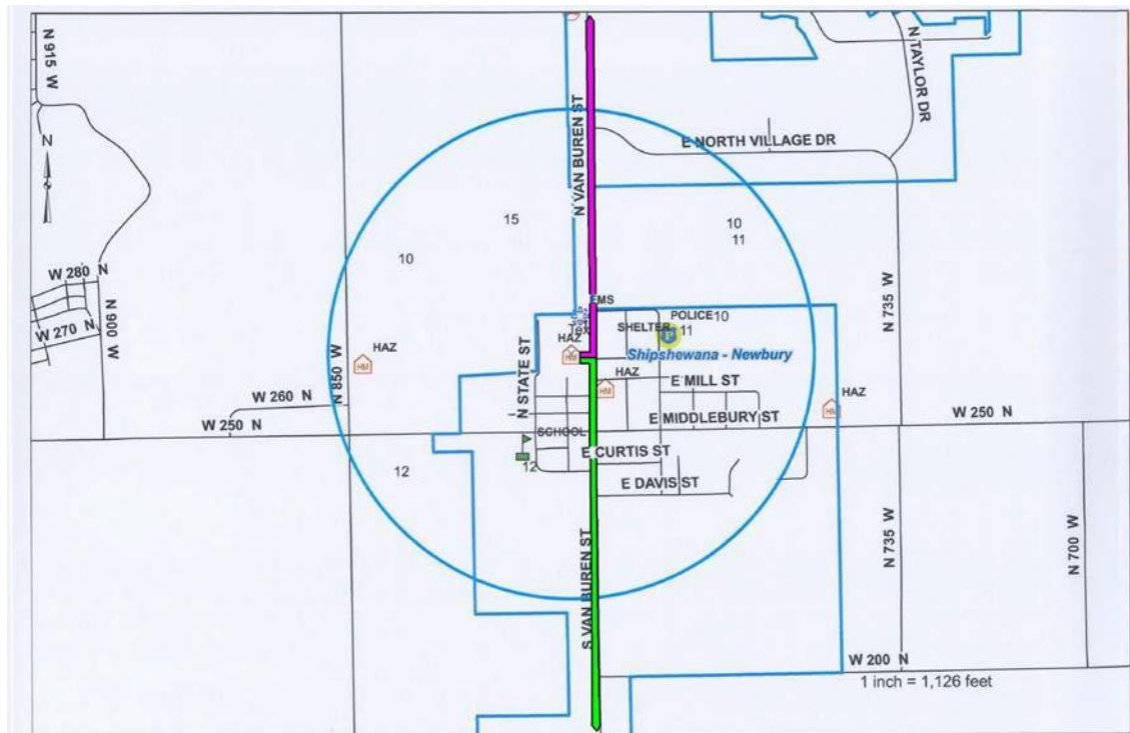

- Suggested Primary Evacuation Route
- Suggested Secondary Evacuation Route
- 2640' Maximum Vulnerability Area for Propane
- 311 Potential Households Affected by the MVA

POTENTIAL AGENCIES TO BE EVACUATED

Emergency Services

| | | |
|--------------------|-----------------|-------------|
| Shipshewana Police | 345 Morton | Shipshewana |
| EMS | 460 N. VanBuren | Shipshewana |

Public Schools

| | | |
|-------------------------------------|--------------------|-------------|
| Shipshewana Scott Elementary School | 325 Middlebury St. | Shipshewana |
|-------------------------------------|--------------------|-------------|

Shelters

| | | |
|----------------|------------|-------------|
| Wolfe Building | 345 Morton | Shipshewana |
|----------------|------------|-------------|

HOOSIER PROPANE-SHIPSEWANA

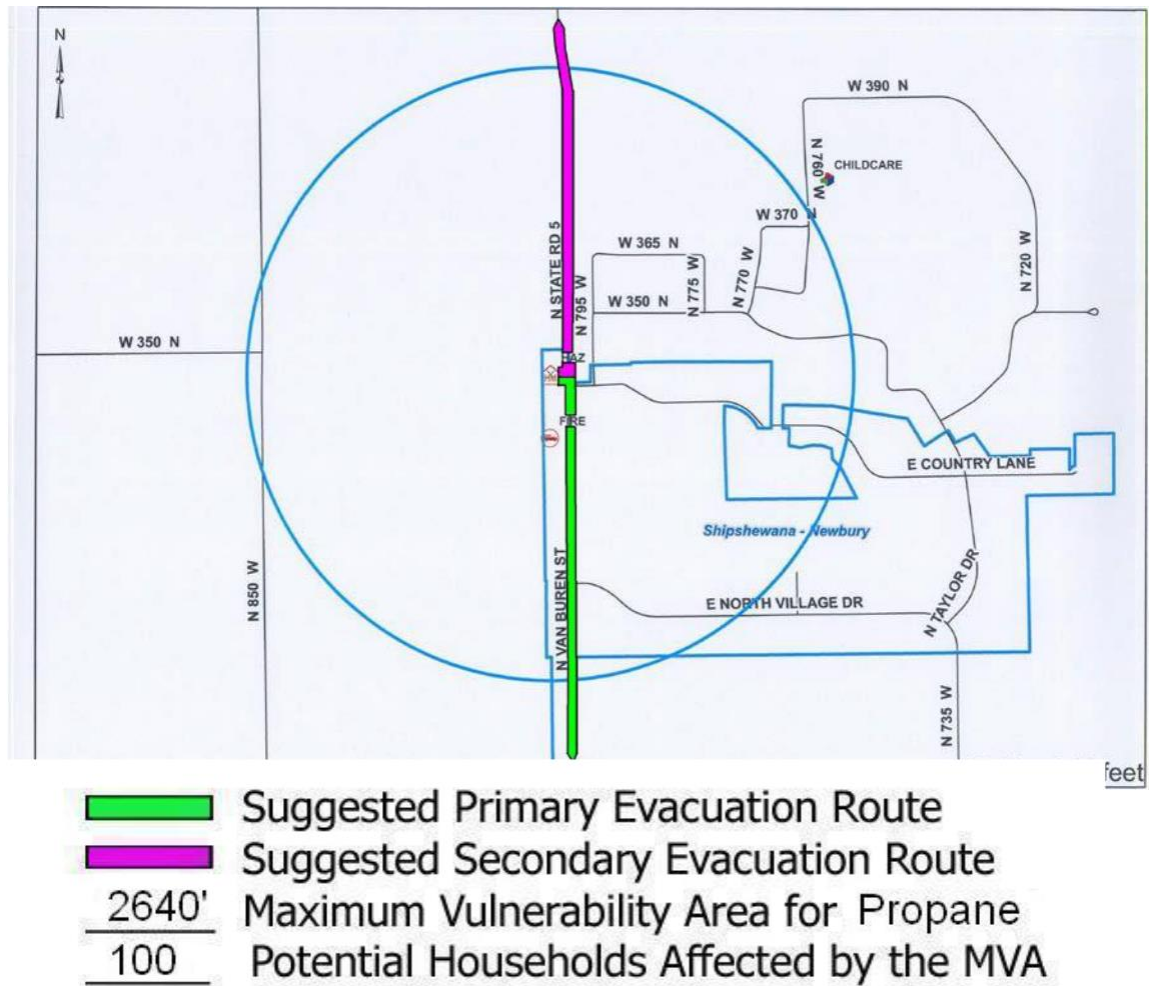

POTENTIAL AGENCIES TO BE EVACUATED





Emergency Services

Shipshewana Fire Department

1100 N. VanBuren Shipshewana

IRVING GRAVEL



-  Suggested Primary Evacuation Route
-  Suggested Secondary Evacuation Route
-  500' Maximum Vulnerability Area for Diesel
-  0 Potential Households Affected by the MVA

POTENTIAL AGENCIES TO BE EVACUATED
NONE

ITR CONCESSION COMPANY, LLC #1 (Indiana Toll Road)

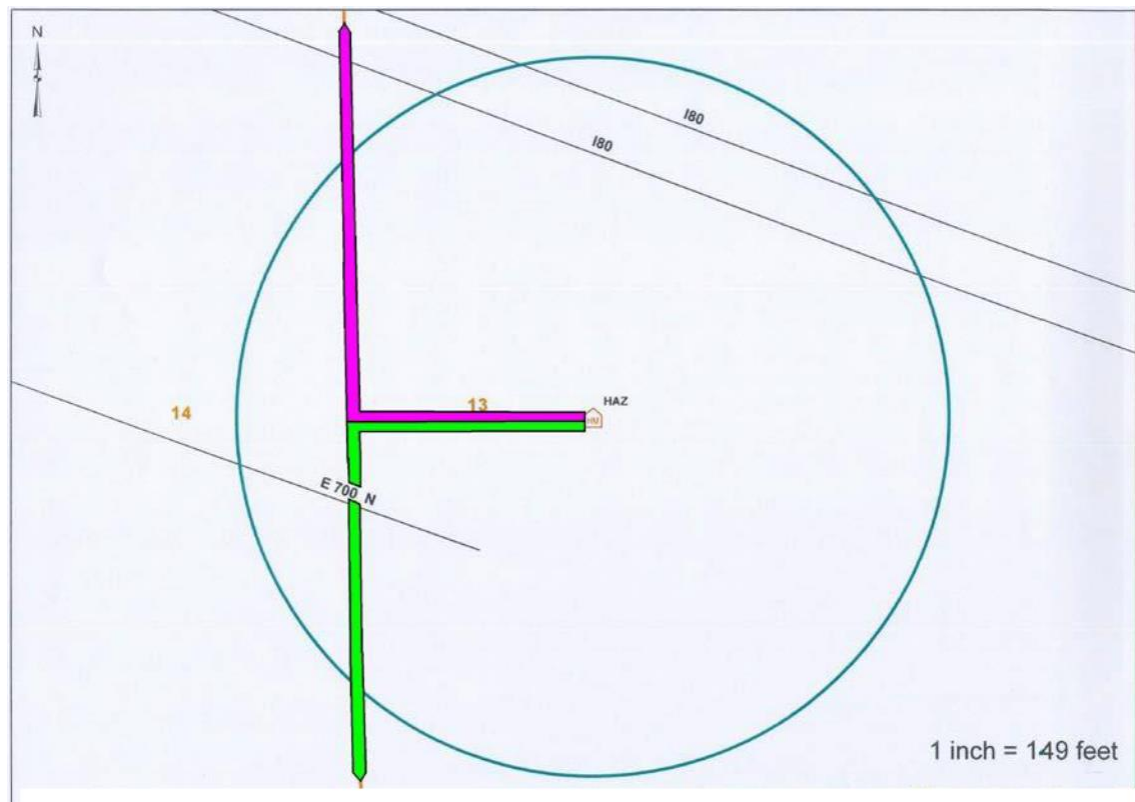

- Suggested Primary Evacuation Route
- Suggested Secondary Evacuation Route
- 500' Maximum Vulnerability Area for Diesel
- 0 Potential Households Affected by the MVA

POTENTIAL AGENCIES TO BE EVACUATED
NONE

ITR CONCESSION COMPANY, LLC #2 (Indiana Toll Road)

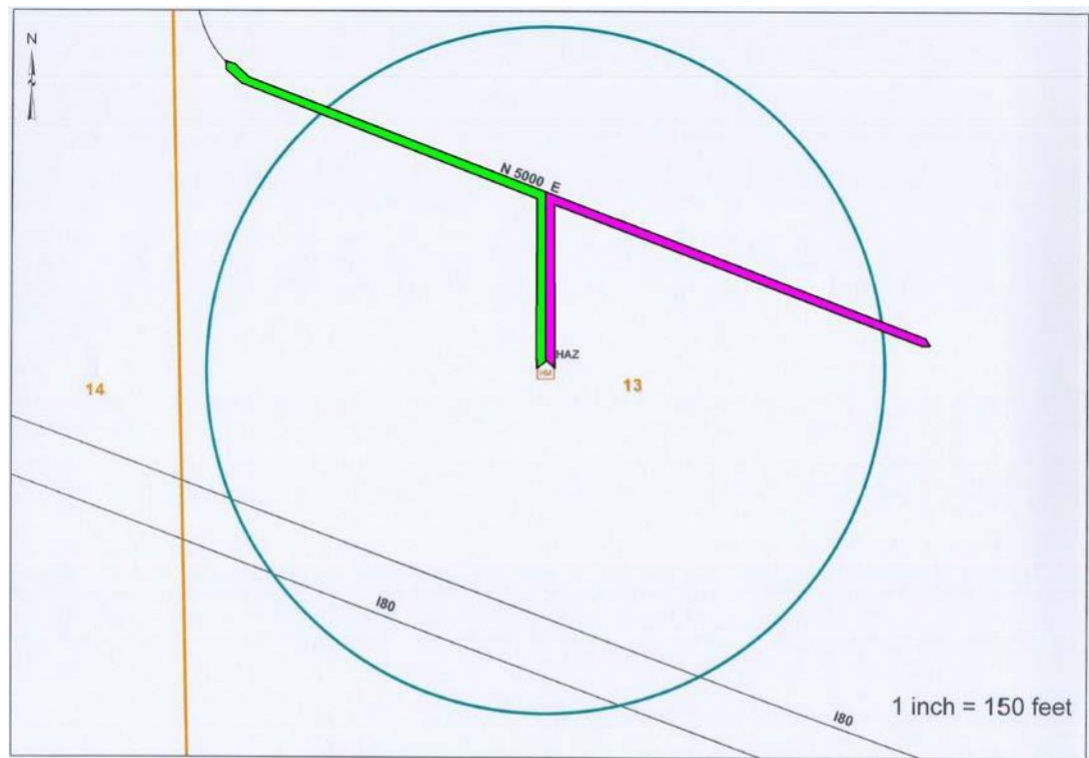



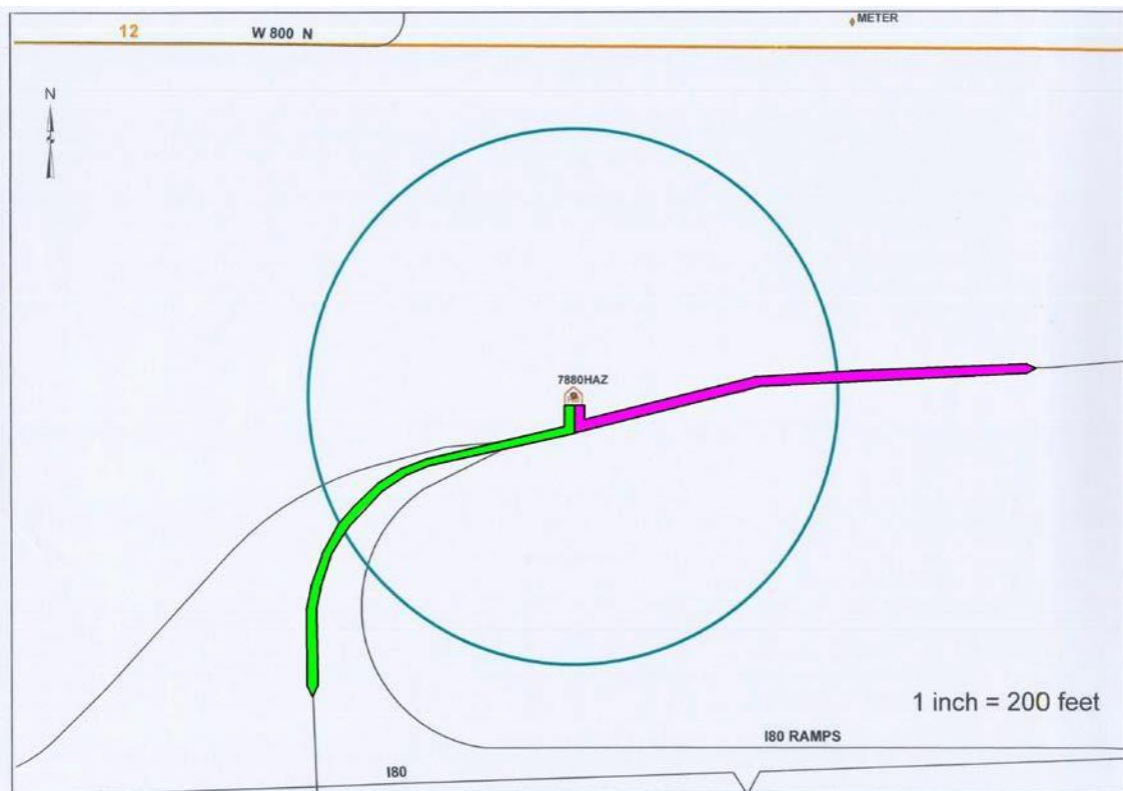

- █ Suggested Primary Evacuation Route
- █ Suggested Secondary Evacuation Route
- 500' Maximum Vulnerability Area for Diesel
- 0 Potential Households Affected by the MVA

POTENTIAL AGENCIES TO BE EVACUATED
NONE

ITR CONCESSION COMPANY, LLC #3 (Indiana Toll Road)

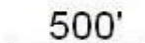



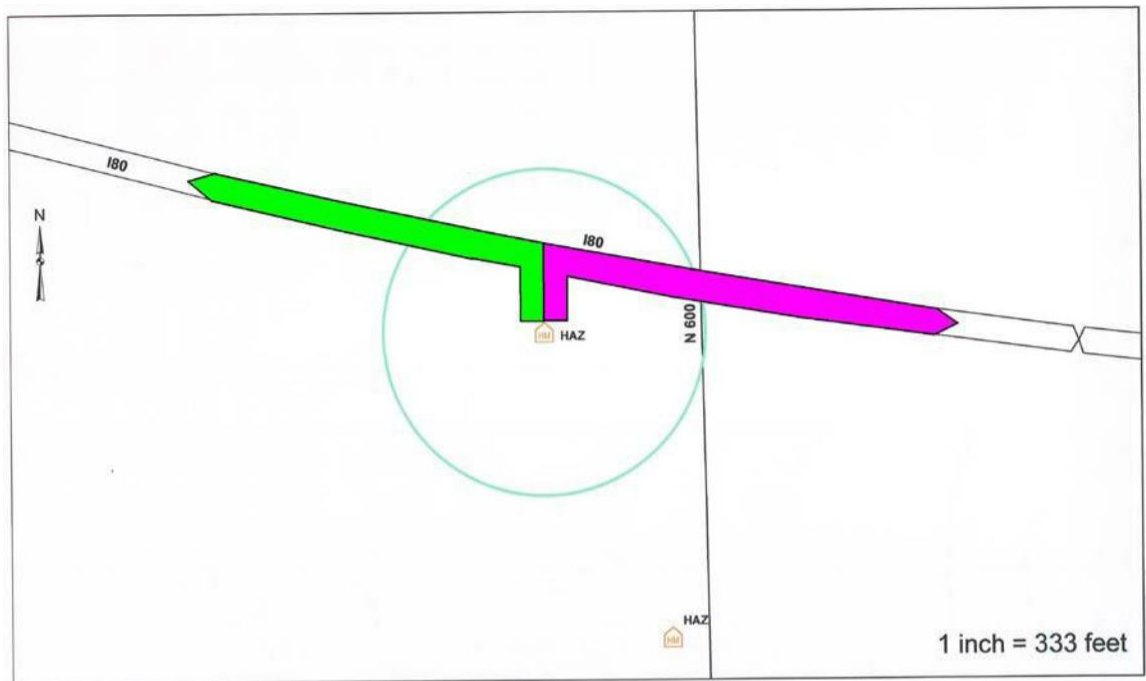

-  Suggested Primary Evacuation Route
-  Suggested Secondary Evacuation Route
-  Maximum Vulnerability Area for Diesel
-  500'
0 Potential Households Affected by the MVA

POTENTIAL AGENCIES TO BE EVACUATED
NONE

ITR CONCESSION COMPANY, LLC #4 (Indiana Toll Road)



-  Suggested Primary Evacuation Route
-  Suggested Secondary Evacuation Route
-  Maximum Vulnerability Area for Diesel
-  Potential Households Affected by the MVA

POTENTIAL AGENCIES TO BE EVACUATED
NONE

K-Z, INC.

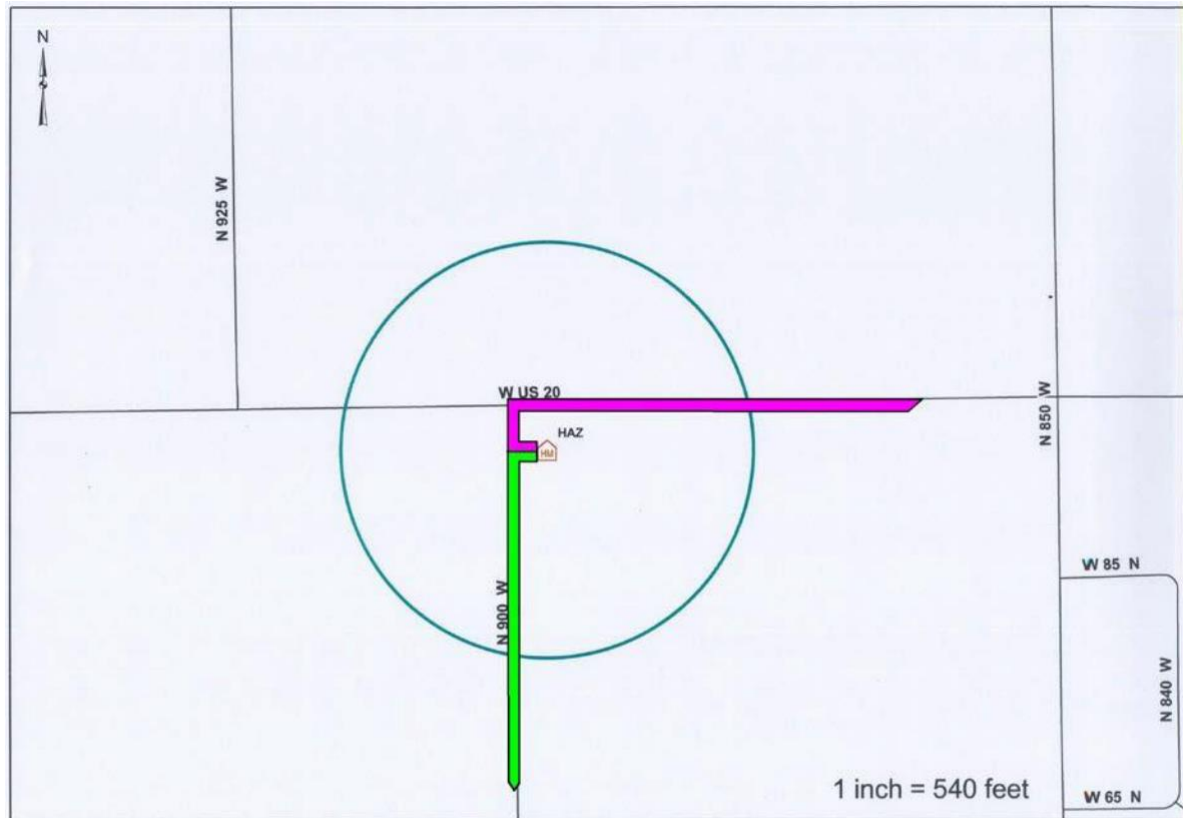



- █ Suggested Primary Evacuation Route
- █ Suggested Secondary Evacuation Route
- 1000' Maximum Vulnerability Area for Propane
- 5 Potential Households Affected by the MVA

POTENTIAL AGENCIES TO BE EVACUATED
NONE

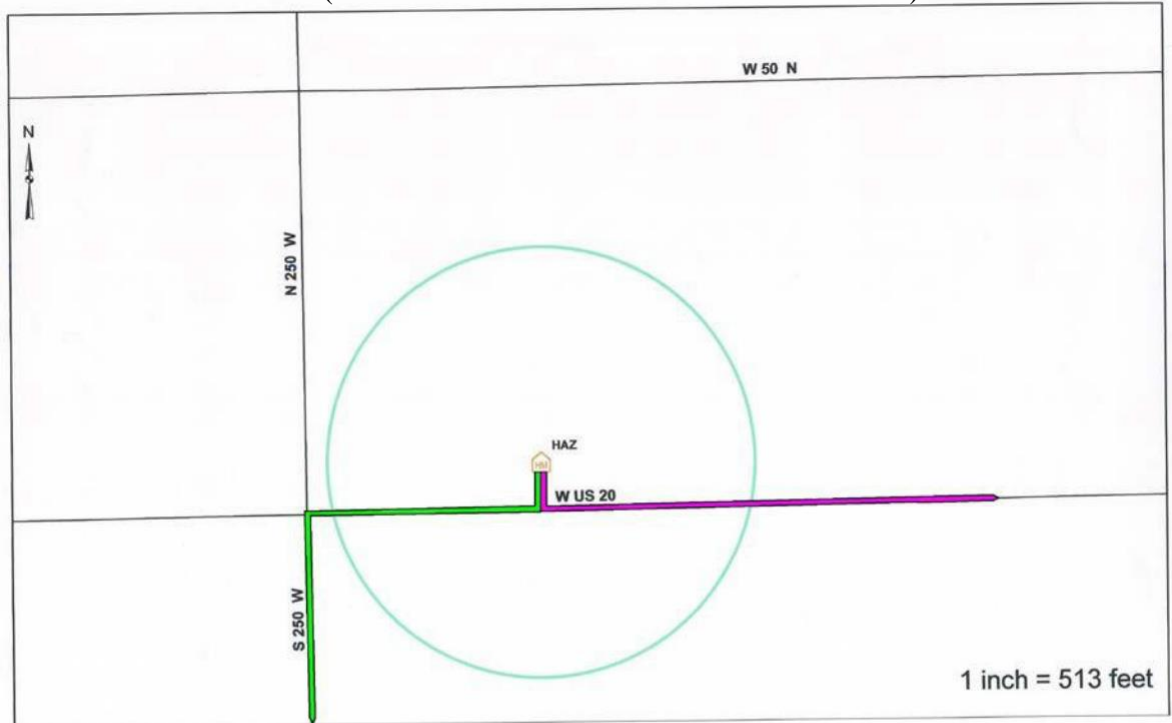
ANR PIPELINE COMPANY
(aka: LAGRANGE COMPRESSOR STATION)

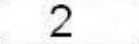

-  Suggested Primary Evacuation Route
-  Suggested Secondary Evacuation Route
-  1000' Maximum Vulnerability Area for Ethylene Glycol
-  2 Potential Households Affected by the MVA

POTENTIAL AGENCIES TO BE EVACUATED
NONE

LAKE PARK INDUSTRIES

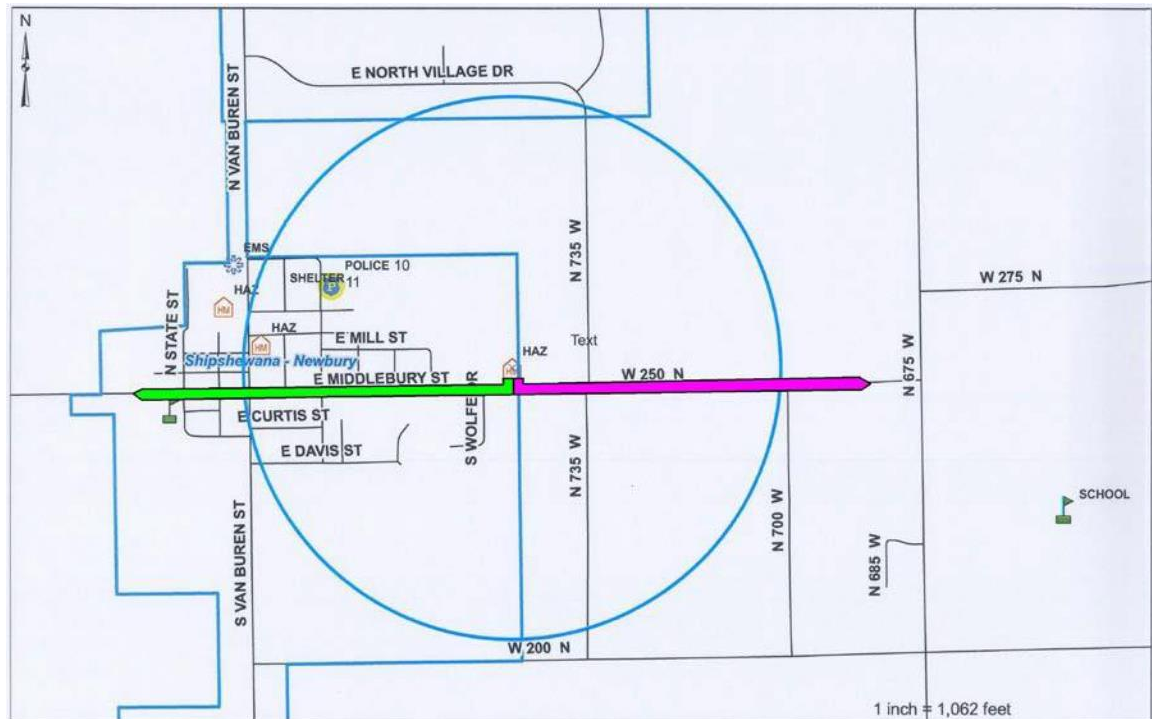

- Suggested Primary Evacuation Route
- Suggested Secondary Evacuation Route
- 2640' Maximum Vulnerability Area for Argon
- 205 Potential Households Affected by the MVA

POTENTIAL AGENCIES TO BE EVACUATED

Emergency Services





| | | |
|--------------------|------------|-------------|
| Shipshewana Police | 345 Morton | Shipshewana |
|--------------------|------------|-------------|

Shelters

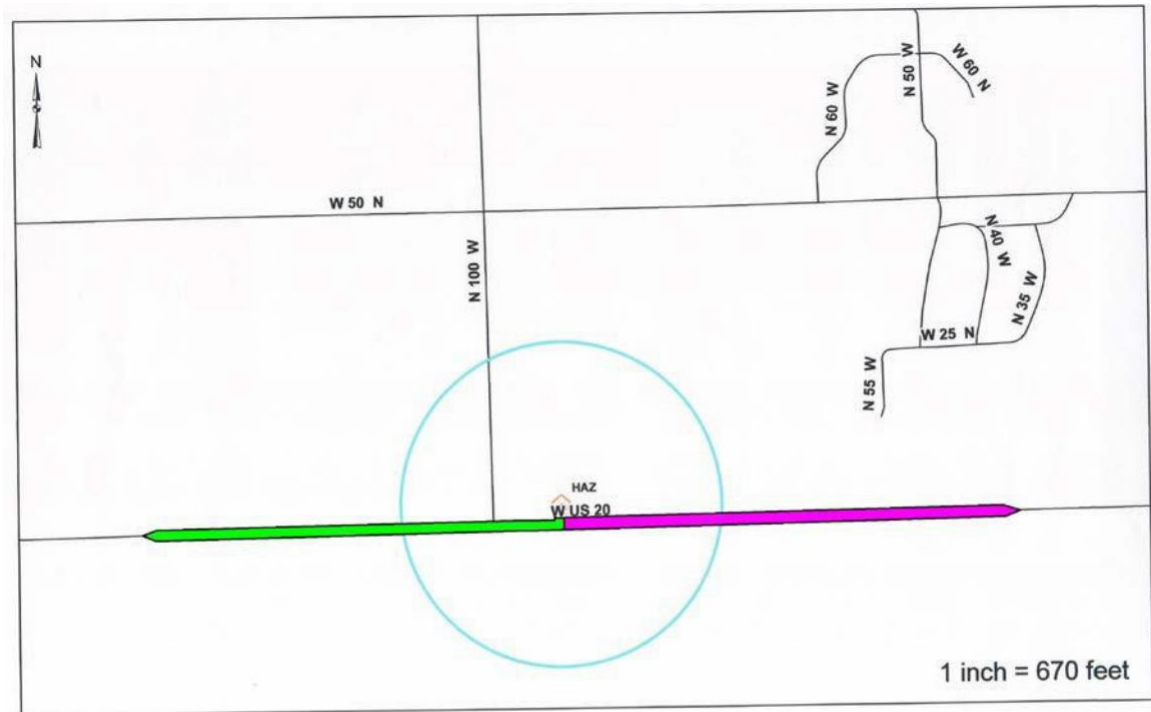
| | | |
|----------------|------------|-------------|
| Wolfe Building | 345 Morton | Shipshewana |
|----------------|------------|-------------|

NORTH CENTRAL COOP

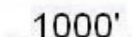

-  Suggested Primary Evacuation Route
-  Suggested Secondary Evacuation Route
-  1000' Maximum Vulnerability Area for Gasoline
-  17 Potential Households Affected by the MVA

POTENTIAL AGENCIES TO BE EVACUATED
NONE

LaGrange County Local Emergency Planning Committee
Hazardous Materials Emergency Response Plan

APPENDIX 7 - NON-EHS FIXED FACILITIES INFORMATION AND FACILITY EMERGENCY COORDINATORS (FECs)

| FACILITY | LAT/LONG | EMERGENCY CONTACTS | PLAN LOCATION | ALARM | EQUIPMENT | TRAINING |
|--|---------------------------|---|-------------------|-------|------------|-------------------|
| FAA –QTZ ARSR 0695S – State Road 9 LaGrange IN 46761 Did Not Report | N41-37.878 W085-24.920 | Bruce Bateman 260-367-0128 (H) Charles Sutton 574-234-2970 24 Hour Line 630-906-8252 | South Bend office | None | None | Company Training |
| Ferrellgas 430 N VanBuren Street Shipshewana IN 46565 | N41-40.715 W085-34.892 | Greg Wetters 574-248-1138 Jeff Parker 765-610-8946 | Posted at pump | None | None | Company Training |
| Hoosier Propane (Shipshewana) 1200 N VanBuren Street Shipshewana 46565 Did Not Report | N41-41.413 W085-34.882 | Steve Slavin 260-768-7213 | Main Office | None | None | Hazwoper Training |
| Irving Gravel 7165E – 400S Now: 7445E – 400S LaGrange IN | N41-35.120 W085-16.994 | Jerry Irving 260-341-5689 Colon Bender 260-410-2206 | Office | None | Absorbents | Company Training |
| | | | | | | |
| | | | | | | |

LaGrange County Local Emergency Planning Committee
Hazardous Materials Emergency Response Plan

| FACILITY | LAT/LONG | EMERGENCY CONTACTS | PLAN LOCATION | ALARM | EQUIPMENT | TRAINING |
|--|-----------------------------------|--|---------------|-------|------------|------------------|
| ITR Concession Company, LLC Hope-LaGrange Toll Plaza 7880N – State Road 9 Howe IN | N41-45.170 W085- 25.288 | Lee Greenamyer 574-904-2674 Bill Warble 574-904-2690 Brian Taylor 574-904-2698 Toll Road Ops – 24 hr 574-651-2480 | Office | None | Spill kits | Company Training |
| ITR Concession Company, LLC Gene Stratton Porter Plaza 7S 7065N - 475E Howe IN | N41- 44.405 W085- 19.457 | Lee Greenamyer 574-904-2674 Bill Warble 574-904-2690 Brian Taylor 574-904-2698 Toll Road Ops – 24 hr 574-651-2480 | Office | None | Spill kits | Company Training |
| ITR Concession Company, LLC Ernie Pyle Plaza 7N 5000E – 750N Howe IN | N41-44.474 W085- 19.458 | Lee Greenamyer 574-904-2674 Bill Warble 574-904-2690 Brian Taylor 574-904-2698 Toll Road Ops – 24 hr 574-651-2480 | Office | None | Spill kits | Company Training |
| ITR Concession Company, LLC LaGrange Maintenance Facility 7200N – 600W Shipshewana IN | N41-44.467 W085- 32.397 | Lee Greenamyer 574-904-2674 Bill Warble 574-904-2690 Brian Taylor 574-904-2698 Toll Road Ops – 24 hr 574-651-2480 | Office | None | Spill kits | Company Training |

LaGrange County Local Emergency Planning Committee
Hazardous Materials Emergency Response Plan

| | | | | | | |
|---|-------------------------------|---|---------------------------------------|-----------------------------------|------------|---|
| ANR Pipeline LaGrange Compressor Station 2255W – US Hwy 20 LaGrange IN 46761 | N41-38.532 W085- 28.206 | Don Ritchie 260-499-2850 800-447-8066 Chase Lyles 615-465-5107 Randy Weber 419-783-3145 | Operations office | Computer audible and visual | Spill kits | Hazwoper Training 1-4 First Responders |
| Lake Park Industries of Indiana 750 E Middlebury Street Shipshewana IN 46565 | N41-40.607 W085- 34.297 | Terry Williams 260-350-1003 Juan Martinez 260-316-6366 | Breakrooms & employee entrances | None | Spill kits | Company Training 2 First Responders |

| FACILITY | LAT/LONG | EMERGENCY CONTACTS | PLAN LOCATIO N | ALARM | EQUIPMENT | TRAINING |
|---|---------------------------|---|---|--|---|--|
| North Central Co-op 0955W – US Hwy 20 LaGrange IN 46761 Did Not Report | N41-38.511 W085-26.591 | Brett Whitehead 260-202-2299 Richard Mishler 260-336-2536 | Main Office | None | Spill kits | Company Training |
| Ceres Solutions Cooperative 955 W US 20 Lagrange, IN 46761 | 41.641889,- 85.443192 | Brett Whitehead 574-202-2298 Richard Mishler 260-336-2536 | Lagrange office and Goshen Office | overflow alarm on the fuel tanks and an emergency stop | Shovels, brooms, oil dry, Spag sorb for spills | monthly safety trainings - three year refresher - LP safety training yearly |
| Keystone RV Company 201 Starcraft Dr, Topeka, IN, 46571 | 41.5332,-85.5463 | Polly Mishler 574-404-1050 Cris Ulmer 574-538-7792 Dan Hill 574-238-7617 | Office | Fire alarm and fire suppression alarms | Absorbent pads and oil dry | Hazcom training and first responder training |

LaGrange County Local Emergency Planning Committee
Hazardous Materials Emergency Response Plan

| | | | | | | |
|---|--------------------------|--|--------------------------------------|------------|------------------|--------------------------|
| INDOT 1305 CR 675 Shipshewana, IN 46565-9910 | 41.659467,- 85.556284 | Brian Hill 260-517-3278 Dennis Warrick 260-341-5919 | Unknown | Unknown | Unknown | Unknown |
| Lassus Bros Oil 400 North Main Street, Wolcottville, IN 46795, United States | 41.532122,- 85.366169 | Audra Depue 260-497-7645 Jon Lassus Jr 260-705-7730 Phil Yarnelle 260-438-8064 | Unknown | Unknown | Unknown | Unknown |
| Lippert 3625 N SR 9, Howe, IN 46746, United States | 41.694187,- 85.425807 | Tim Stickler 574-210-630 Tony Ferrara 574-315-2226 Jeff Holsinger 574- 312-6648 | In Office | Fire Alarm | No | First responders on site |
| Parkview LaGrange Hospital 207 North Townline Rd., LaGrange, IN 46761 | 41.645402,- 85.425847 | Robert Bloomfield 260-242-6851 Jeremy Hoover 260-463-1778 | Online, command center, office | yes | Small spill kits | Company training |

APPENDIX 8 - TRAINING AND EXERCISE PROGRAM/SCHEDULE

LaGrange County has developed an emergency response training program for HazMat responders. The program is designed to train fire department personnel in the use of emergency response equipment and procedures to protect life health and safety in the event of a HazMat release. The training is organized to cover emergency equipment, petroleum spill emergencies, HazMat response procedures, and simulated spill responses.

In 40 CFR 311, the EPA adopted training rules, promulgated by OSHA in 29 CFR 1910.120, which require specific training for all "public employees" who respond to hazardous materials incidents, effective 6 March 1990. Different levels of training are required for first responders hired after the effective date of this rule, depending on the duties and functions performed by each. All responders, however, must complete the training or demonstrate competency at their respective level of response.

At a minimum, firefighters expected to respond to a HazMat release should receive training equivalent to First Responder Operations Level training as described by OSHA's HAZWOPER Standard (29 CFR 1910.120). This training includes an 8-hour initial training course and annual refresher training. It is not expected that firefighters will go beyond the initial containment of an emergency HazMat release. Further actions required by an emergency release will be taken by HazMat teams who have been trained to conduct such activities.

The County EMA maintains records of personnel who have completed training courses. These records are updated regularly to reflect refresher training.

Exercises and drills shall be conducted periodically to evaluate the adequacy of the *Hazardous Materials Emergency Response Plan* and the skills of the emergency response personnel. Results of exercises and drills provide a basis for changes in the response plans, implementation procedures, and for future emergency response training for personnel. Each of the response agencies and responsible parties mentioned in this Plan will be invited to take part in the exercise.

Training required for emergency personnel is identified in Table 8-1.

Below is the LaGrange County LEPC 5-year Training Plan

| Training Date | Training Type | Training Topic |
|---------------|------------------------|--|
| 2020 | Waived due to COVID-19 | n/a |
| 2021 Fall | Seminar | Hazardous Materials Awareness and Operations |
| 2022 | Seminar | HAZWOPER for Industry |
| 2023 | Seminar | Hazardous Material Technician |
| 2024 | Seminar | Hazardous Materials Awareness and Operations |

TYPES OF EXERCISES CONDUCTED

Discussion-based exercises include seminars, workshops, tabletop exercises (TTXs), and games. These types of exercises typically highlight existing plans, policies, mutual aid agreements, and procedures. This makes them exceptional tools for familiarizing agencies and personnel with current or expected jurisdictional capabilities. Discussion-based exercises typically focus on strategic, policy-oriented issues, whereas operations-based exercises tend to focus more on tactical response-related issues.

Operations-based exercises represent the next iteration of the exercise cycle; they are used to validate the plans, policies, agreements, and procedures solidified in discussion-based exercises. Operations-based exercises include drills, functional exercises (FEs), and full scale exercises (FSEs).

TABLETOP EXERCISES

Tabletop exercises involve senior staff, elected or appointed officials, or other key personnel in an informal setting, discussing simulated situations. This type of exercise is intended to stimulate discussion of various issues regarding a hypothetical situation. It can be used to assess plans, policies, and procedures or to assess types of systems needed to guide the prevention of, response to, and recovery from a defined event.

FUNCTIONAL EXERCISES

The functional exercise, also known as a command post exercise (CPX), is designed to test and evaluate individual capabilities, multiple functions or activities within a function, or interdependent groups of functions. Functional exercises are generally focused on exercising the plans, policies, procedures, and staff for the direction and control nodes of Incident Command (IC) and Unified Command (UC).

FULL-SCALE EXERCISES

The full-scale exercise is the most complex step in the exercise cycle. Full-scale exercises are multi-agency, multi-jurisdictional exercises that test many facets of emergency response and recovery.

A full-scale exercise focuses on implementing and analyzing the plans, policies, and procedures developed in discussion-based exercises and honed in previous, smaller, operations-based exercises. The events are projected through a scripted exercise scenario with built-in flexibility to allow updates to drive activity. It is conducted in a real-time, stressful environment that closely mirrors a real event. First responders and resources are mobilized and deployed to the scene where they conduct their actions as if a real incident had occurred (with minor exceptions).

Below is the LaGrange County LEPC 5-year Exercise Plan

| Exercise Date | Exercise Type | Exercise Scenario |
|---------------|---------------|-------------------|
| 2021 | Tabletop | Roadway |
| 2022 | Functional | Roadway |
| 2023 | Tabletop | Physical site |
| 2024 | Functional | Physical site |
| 2025 | Tabletop | TBD |

LaGrange County Local Emergency Planning Committee
Hazardous Materials Emergency Response Plan

| TRAINING NEEDED | HAZMAT TEAM | FIRE & RESCUE | LAW ENFORCEMENT | EMS | PUBLIC HEALTH | EMERGENCY MGMT | SUPPORT AGENCY | SCHOOL BOARD | HOSPITAL | FACILITY OPERATOR |
|--|-------------------|-------------------|-------------------|-------------------|---------------|-------------------|----------------|--------------|-------------------|-------------------|
| First Responder Awareness Level | X | X | X | X | X | X | X | X | X | X |
| First Responder Operations Level | X | X | | | | X | | | Note ¹ | X |
| Hazardous Materials Technician Level | X | | | | | | | | | |
| Hazardous Materials Specialist Level | X | | | | | | | | | |
| On-Scene Incident Command Level ³ | X | X | X | X | X | X | X | X | | X |
| Safety Operations | Note ¹ | | X | X | | | | | | |
| Use of Protective Clothing/Equipment | Note ² | X | | X | | X | | | | |
| Decontamination Procedures | Note ² | X | | X | | | | | X | |
| Treatment of Contaminated Patient Injuries | | X | | X | | | | | X | |
| ICS100 | X | X | X | X | X | X | X | X | X | X |
| ICS200 | X | X | X | X | X | X | X | | X | X |
| ICS300 | Note ⁴ | Note ⁴ | Note ⁴ | Note ⁴ | | X | | | | |
| ICS400 | Note ⁴ | Note ⁴ | Note ⁴ | Note ⁴ | | Note ⁴ | | | | |
| ICS700: NIMS | X | X | X | X | X | X | X | | X | X |
| ICS800(b): NRF | X | X | X | X | X | X | | | X | |

¹ Required for Hospital Emergency Room and Safety Personnel

²These training modules are covered in the Hazardous Materials Technician training level and are required for supervisory personnel needing additional training beyond First Responder Levels.

³New Incident Command Training Requirements under National Incident Management System (NIMS)

⁴These course are required only for command and general staff, select department heads with multi-agency coordination system responsibilities, area commanders, and emergency managers .

LaGrange County Local Emergency Planning Committee
Hazardous Materials Emergency Response Plan

| HAZMAT CERTIFICATION LEVELS | | | | | |
|--------------------------------------|-----------------|------------------|------------------|------------------|------------------|
| FIRE DEPARTMENTS | AWARENESS LEVEL | OPERATIONS LEVEL | TECHNICIAN LEVEL | INCIDENT COMMAND | FIRST RESPONDERS |
| Howe Fire Dept. | 3 | 22 | 0 | 7 | 12 |
| Johnson Twp Fire Dept. | 7 | 16 | 0 | 3 | 13 |
| LaGrange Fire Dept. | 4 | 12 | 0 | 5 | 9 |
| Mongo VFD | 3 | 8 | 0 | 2 | 12 |
| Shipshewana Fire Dept. | 0 | 25 | 0 | 4 | 13 |
| Stroh VFD | 4 | 18 | 0 | 7 | 15 |
| Topeka Fire Dept. | 28 | 28 | 0 | 9 | 13 |
| EMERGENCY MEDICAL SERVICES | AWARENESS LEVEL | OPERATIONS LEVEL | TECHNICIAN LEVEL | INCIDENT COMMAND | |
| Parkview-LaGrange EMS | 0 | 39 | 0 | 6 | 0 |
| EMERGENCY MANAGEMENT | AWARENESS LEVEL | OPERATIONS LEVEL | TECHNICIAN LEVEL | INCIDENT COMMAND | |
| LaGrange County EMA | 0 | 1 | 0 | 1 | 0 |
| LAW ENFORCEMENT | AWARENESS LEVEL | OPERATIONS LEVEL | TECHNICIAN LEVEL | INCIDENT COMMAND | |
| LaGrange County Sheriff's Department | 18 | 0 | 0 | 4 | 0 |
| LaGrange Police Dept. | 12 | 1 | 0 | 2 | 0 |
| Shipshewana Police Dept. | 11 | 0 | 0 | 2 | 0 |
| Topeka Police Dept. | 5 | 0 | 0 | 1 | 0 |
| Wolcottville Police Dept. | 9 | 0 | 0 | 1 | 0 |

LaGrange County Local Emergency Planning Committee
Hazardous Materials Emergency Response Plan

| 2021 PROJECTED HAZMAT TRAINING SCHEDULES | | | | | | |
|--|----------------------|-----------------------|-----------------------|------------------------|-------------------------|-------------------------|
| FIRE DEPTS. | AWARENESS | OPERATIONS | TECHNICIAN | AWARENESS REFRESHER | OPERATIONS REFRESHER | TECHNICIAN REFRESHER |
| Howe Fire Dept. | | | | Annual | Annual | |
| Johnson Twp Fire Dept. | | | | Annual | Annual | |
| LaGrange Fire Dept. | | | | Annual | Annual | |
| Mongo VFD | | | | Annual | Annual | |
| Shipshewana Fire Dept. | | | | Annual | Annual | |
| Stroh VFD | | | | Annual | Annual | |
| Topeka Fire Dept. | | | | Annual | Annual | |
| EMERGENCY MEDICAL SERVICES | AWARENESS COURSES | OPERATIONS COURSES | TECHNICIAN COURSES | AWARENESS REFRESHER | OPERATIONS REFRESHER | TECHNICIAN REFRESHER |
| Parkview-LaGrange EMS | | | | Annual | Annual | |
| EMERGENCY MANAGEMENT | AWARENESS LEVEL | OPERATIONS LEVEL | TECHNICIAN LEVEL | AWARENESS REFRESHER | OPERATIONS REFRESHER | TECHNICIAN REFRESHER |
| LaGrange County EMA | | | | Annual | Annual | |
| LAW ENFORCEMENT | AWARENESS LEVEL | OPERATIONS LEVEL | TECHNICIAN LEVEL | AWARENESS REFRESHER | OPERATIONS REFRESHER | TECHNICIAN REFRESHER |
| LaGrange County Sheriff's Department | | | | Annual | | |
| LaGrange Police Dept. | | | | Annual | Annual | |
| Shipshewana Police Dept. | | | | Annual | | |
| Topeka Police Dept. | | | | Annual | | |
| Wolcottville Police Dept. | | | | Annual | | |

| WRITTEN HAZMAT STANDARD OPERATING PROCEDURES/GUIDELINES | | |
|--|---------------|------------------|
| FIRE DEPARTMENTS | YES/NO | LOCATION |
| Howe Fire Dept. | Yes | Office |
| Johnson Twp Fire Dept. | Yes | Office |
| LaGrange Fire Dept. | Yes | Station/Vehicles |
| Mongo VFD | No | |
| Shipshewana Fire Dept. | Yes | Office |
| Stroh VFD | No | |
| Topeka Fire Dept. | Yes | Station/Vehicles |
| EMERGENCY MEDICAL SERVICES | YES/NO | LOCATION |
| Parkview-LaGrange EMS | Yes | Office-Vehicles |
| EMERGENCY MANAGEMENT | YES/NO | LOCATION |
| LaGrange County EMA | No | |
| LAW ENFORCEMENT | YES/NO | LOCATION |
| LaGrange County Sheriff's Department | No | |
| LaGrange Police Dept. | No | |
| Shipshewana Police Dept. | No | |
| Topeka Police Dept. | Yes | Office |
| Wolcottville Police Dept. | No | |

APPENDIX 9 – MEDIA CONTACTS

| Newspaper Media | Phone/Fax | Website |
|--|---|--|
| Albion New Era 407 N Orange Street Albion IN | 260-636-2727 | |
| LaGrange Standard 0410E-100S LaGrange IN | 260-463-2166 | editor@lagrangepublishing.com |
| The Advance Leader 121 S Calvin Street Ligonier IN | 260-894-3102 | www.kpcnews.com |
| The News-Sun 102 N Main Street Kendallville IN | 260-347-0400 800-717-4679 | www.kpcnews.com |
| Fort Wayne Journal Gazette Fort Wayne News Sentinel 600 W Main Street Fort Wayne IN 46801 | 260-461-8201 260-461-8354 800-324-0505 | jgnews@jg.net nsmetro@news-sentinel.com |
| Radio Stations | Phone/Fax | Website |
| Thunder Country WTHD 105.5FM 206 South High Street LaGrange IN 46761 | 260-463-8500 800-856-1055 (after hrs-Angola office) | wthd.net |
| WLDE Radio 101.7FM WJJI Radio 95.1FM 347 W Berry, Ste #417 Fort Wayne IN 46816 | 260-423-3676 | leetobin@wlde.com |
| WOWO Radio 1190AM 2915 Maples Road Fort Wayne IN 46816 | 260-447-6397 260-447-2110 260-447-1190 (cell) 385-2592 | news@wowo.com |
| WZOC 94.3 FM South Bend 112 W Washington Street Plymouth IN 46746563 | 888-943-6539 574-936-4096 | |
| WLKI 100.3FM 2655N - SR 127 Angola IN | 260-655-9554 | www.wlki.com |
| WAWK 1140 AM 931 EAST AVENUE KENDALLVILLE IN 46755 | 260-347-2400 260-349-8140 (cell) | |
| WFWI Radio 92.3 FM The Bear 98.9 FM 1005 Production Rd Fort Wayne IN 46808 | 260-471-1929 hot line 484-1062 | |

LaGrange County Local Emergency Planning Committee
Hazardous Materials Emergency Response Plan

| WBCL Radio 90.3 FM 1025 W Rudisell Blvd Fort Wayne IN 46807 | 260-745-0576 or Craig Albrecht (cell) 437-9483 | news@wbcl.org | |
|---|--|--|--|
| Television- Indiana | Phone/Fax | Website | |
| WNDU TV16 NBC 54516 SR 933 South Bend IN 46617 | 574-631-6397 | Newscenter16@wndu.com | |
| WSBT TV22 CBS 1301 E Douglas Rd Mishawaka IN 46545 | 574-232-2838 (Non-Published) | news@wsbt.com | |
| WSJV TV28 FOX 58096 CR 7 South Elkhart IN 46517 | 574-679-4545 | fox28@fox28.com | |
| WANE TV (CBS) – Channel 15 2915 W State Blvd Fort Wayne IN 46808 | Hot line 422-5644 260-424-1515 FAX 424-6054 | newsrelease@wane.com | |
| WPTA TV (ABC) - Channel 21 WKJG TV (NBC) - Channel 33 3401 Butler Road Fort Wayne IN 46808 | 260-483-8111 260-471-9913 | newsroom@indianasnewscenter.com | |
| WFWA PBS Channel 39 2501 E Coliseum Blvd Fort Wayne IN 46805 | (Daytime admin.) 260-484-8839 Master control room 260-471-5642 | info@wfw.org | |
| Television- Cable | Phone/Fax | Website | |
| COMCAST TV 720 Taylor Rd Fort Wayne IN MEDIACOM – Cable TV-70 MediaCom Communications Corp 931 East Avenue Kendallville IN 46774 | 888-266-2278 260-347-4408 800-874-2924 | www.comcast.com | |

APPENDIX 10 - POPULATION PROTECTION INFORMATION (SHELTER-IN-PLACE AND EVACUATION)

GENERAL INFORMATION

Protective action decisions are very incident-specific and the use of judgment will be necessary. If the release occurs over an extended period of time, or if there is a fire that cannot be controlled within a short time, then evacuation may be the sensible option. Evacuation during incidents involving the airborne release of extremely hazardous substances is sometimes, but by no means always, necessary. Airborne toxicants can be released and move downwind so rapidly that there would be no time to evacuate residents. For short-term releases, often the most prudent course of action for the protection of the nearby residents would be to remain inside with the doors and windows closed and the heating and air conditioning systems shut off. An airborne cloud will frequently move past quickly. Vulnerable populations, such as the elderly and sick, may sustain more injury during evacuation than they would by staying inside and putting simple countermeasures into effect.

There are other disadvantages associated with evacuation during incidents involving airborne releases of extremely hazardous substances. Changes in wind velocity and direction are difficult to predict and could be very important if evacuation were undertaken during a release. Differences in temperature between air layers could also cause the toxic cloud to disperse in ways that would be hard to predict. These factors and others make it difficult to estimate how long the community would be exposed to a toxic cloud. Also, no safe exposure or concentration levels have been established for the general population with regard to releases of chemicals included on the list of extremely hazardous substances.

In the event of a local hazardous materials spill or other emergency, the first thing the public can anticipate is a radio/television broadcast from the LaGrange County Emergency Management Agency, a knock on the door, or an announcement by loud speaker from an emergency vehicle (police, fire, or rescue) driving through the affected area to alert residents. Public announcements will be made on local cable television and on local radio stations as quickly as possible, depending on how wide-spread the affected area may be.

IN-PLACE SHELTERING

In-place sheltering may be a sensible course of action, when the risks associated with an evacuation are outweighed by the benefits of in-place sheltering. In order for this protection measure to be effective, the affected population must be advised to follow the guidelines listed below:

- Close all doors to the outside and close and lock all windows. Windows seal better when locked. Seal gaps under doorways and windows with wet towels and those around doorways and windows with duct tape or similar thick tape.

- Building superintendents should set all ventilation systems to 100% recirculation so that no outside air is drawn into the structure. Where this is not possible, ventilation systems should be turned off.

Turn off all heating systems and air conditioners.

- Seal any gaps around window type air conditioners, bathroom exhaust fan grilles, range vents, dryer vents, etc., with tape and plastic sheeting, wax paper, or aluminum wrap.

- Turn off and cover all exhaust fans in kitchens, bathrooms, and other spaces. Close all fireplace dampers.

Close as many internal doors as possible in homes or other buildings.

If an outdoor explosion is possible, close drapes, curtains, and shades over windows. Stay away from windows to prevent potential injury from flying glass.

If you suspect that the gas or vapor has entered the structure you are in, hold a wet cloth over your nose and mouth.

Tune in to the Emergency Alert System channel on the radio or television for information concerning the hazardous materials incident and in-place sheltering.

DO NOT leave the home or let pets outside until an "all clear" advisory is given. After an "all clear" message is given for the area, open your windows and doors to air out your home.

It should be understood that following the above guidelines will increase the effectiveness of in-place sheltering as a protective action. However, following these guidelines does not ensure that this type of protective action will indeed be effective.

EVACUATION PROCEDURES

A decision to evacuate those persons considered at risk from a release may have to be made by an Incident Commander due to the limited time available. Though evacuations are normally considered voluntary in the State of Indiana, in some cases the presence of people could compound life, health, and safety issues; and therefore, evacuation could be forced. Risk analysis and pre-planning will be used to determine evacuation plans for an incident.

Key factors in deciding upon an evacuation must include situation, location, and resource factors:

1. Situation factors include:

- Actual situation and conditions (leak, fire, spill, explosion)
- The products involved (physical/chemical properties)
- Hazards of the products
- Dispersal patterns
- Status of the containers
 - Size and duration of the release
 - Atmospheric conditions
- Ability of the products to migrate off site

2. Location factors include:

- Location of the incident and containers
- Size of affected population in imminent danger
- Risks in moving people versus sheltering-in-place
 - Types (ages, mobility, business, residential, etc.) of affected population
 - Ability to shelter non-ambulatory populations in place

3. Resource factors include:

- Ability to shelter evacuated populations off site
- Ability to notify and move the affected population in a timely manner

In addition to the above considerations, the LEPC must determine what persons will require special assistance in evacuating the area and whether any barriers exist to communication between evacuees and evacuation assistance personnel. Special consideration should be given to:

- Persons lacking private transportation
- The elderly

Children

Special needs populations

Prisoners

Non-English speaking persons

If the Incident Commander calls for an evacuation during an incident, consideration needs to be given to security. Public property must be guarded by the proper authorities to avoid any elements of harm or vandalism. Once public re-entry has been approved, security for the evacuated site should take caution to watch who is re-entering at this time.

When evacuating residents from an affected area, efforts will be made to always try to use main roads and highways. The prevailing wind for LaGrange County is generally from the south-southwest (SSW) direction. For planning purposes only, this has been utilized in this study. The person or personnel in charge of any evacuation will be responsible to know the best direction of an evacuation at the time it is needed.

EVACUATION ROUTES

The attached facility maps of hazardous materials sites show primary and secondary evacuation routes. The primary routes were determined by using the main transportation route out of the area. Secondary routes were determined by the amount of traffic that can be handled and the accessibility to that road. Both take into consideration prevailing wind direction being south-southwest. In case of emergency, law enforcement may determine other routes for evacuation depending on wind direction and location of release. These are only suggested routes.

EVACUATION SHELTERS

The Elkhart County Chapter of the American Red Cross has identified community emergency shelters and shelter managers for each facility to house evacuees. The Red Cross may utilize these shelters for any community disaster. In the case of an evacuation due to a HazMat incident, the Incident Commander should work with the Red Cross in determining the safest shelters to activate. Residents should follow the directions given in the evacuation announcements.

The Red Cross will also track evacuees and make any sheltered members' names available in accordance with their established SOPs.

LaGrange County Local Emergency Planning Committee
Hazardous Materials Emergency Response Plan

LaGrange County Red Cross Shelters *Red Cross Primary Point of Contact: Linda Nelson, Director*
Elkhart Co. Chapter of American Red Cross, Office 574-293-6519, Emergency cell (574-612-2406)

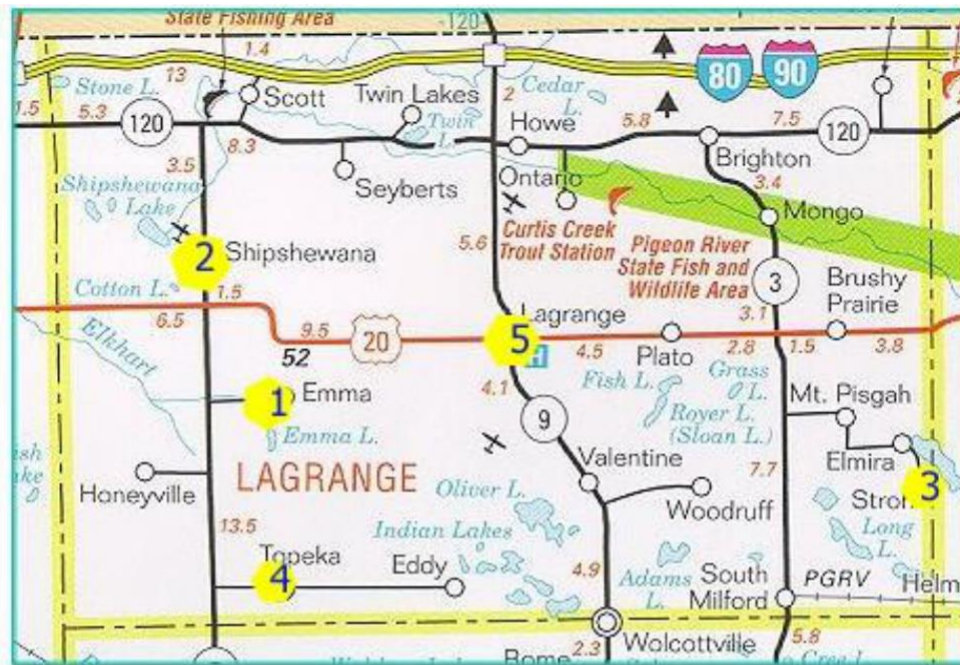

| | | |
|---|---|---------------------------------|
| 1 | Emma Mennonite Church 1900 S – 600 W Topeka IN | 260-593-2036 |
| 2 | Wolfe Community Building 345 N Morton Street (beside Police Department) Shipshewana IN | Saraetta Miller 260-768-4358 |
| 3 | Stroh Church of Christ 4540 S-1100 W Hudson IN (physically located in Steuben Co.) | Mike Hamm 260-351-4626 |
| 4 | Maple Grove Church, Inc. 806 S Main Street Topeka IN | 260-593-2844 |
| 5 | LaGrange United Methodist Church 209 W Spring Street LaGrange IN | Chris Danielson 260-463-2859 |

APPENDIX II - EXERCISE EVALUATION FORMS/CHECKLISTS

The County will follow the FEMA guidelines contained in the publication *Hazardous Materials Exercise Evaluation Methodology (HM-EEM)* for evaluation of exercises as well the *Homeland Security Exercise and Evaluation Plan (HSEEP)* evaluation criteria.

BASICS FOR EXERCISE EVALUATION

The first and most frequent basis for evaluation of an exercise is a determination on the part of State and local governments that it would be useful to their hazardous materials emergency preparedness programs to have their performance in a hazardous material exercise evaluated. They may seek such an evaluation in order to increase the value of the exercise as a test of the adequacy and the ability to implement their response plan, as a measure of the adequacy of training efforts, or as an indicator of their general level of preparedness for response to a hazardous materials incident.

The second basis for evaluation of an exercise is the existence of a statutory requirement that a State or local government conduct evaluated hazardous materials exercises.

The third basis for evaluation of an exercise is a joint decision by local, State, and Federal government that their mutual interests in greater hazardous materials emergency preparedness, arising from separate but interrelated legal foundations, and would be promoted by the conduct of a joint evaluated exercise.

| OBJECTIVE DESCRIPTIONS | |
|------------------------|---|
| Objective 1 | Demonstrate the ability to notify response agencies and to mobilize emergency personnel. |
| Objective 2 | Demonstrate the ability to direct, coordinate, and control emergency response activities through operations of an Incident Command System (ICS) and other direction and control structures. |
| Objective 3 | Demonstrate the ability to identify the hazardous material(s) involved in an incident/accident and to assess the hazards associated with the material involved during both the emergency and post-emergency phases. |
| Objective 4 | Demonstrate the ability to mobilize and manage resources required for emergency response. |
| Objective 5 | Demonstrate the ability to establish and maintain communications essential to support response to an incident/accident. |
| Objective 6 | Demonstrate the adequacy of facilities, equipment, displays, and other materials to support emergency operations. |
| Objective 7 | Demonstrate the ability to signal an alert and to provide emergency notification containing information and instructions to the public. |
| Objective 8 | Demonstrate the ability to coordinate the development and dissemination of clear, accurate, and timely information to the media. |
| Objective 9 | Demonstrate the capability to decide upon directing the implementation of protective actions for the public. |
| Objective 10 | Demonstrate the ability to protect emergency responder's health and safety. |
| Objective 11 | Demonstrate the organizational ability and resources necessary to implement site security and to control evacuation traffic flow and access to evacuated and sheltered areas. |

LaGrange County Local Emergency Planning Committee
Hazardous Materials Emergency Response Plan

| OBJECTIVE DESCRIPTIONS | |
|------------------------|---|
| Objective 12 | Demonstrate the ability to monitor and control hazardous materials decontamination of the public through an appropriate contamination screening, decontamination, and registration process. |
| Objective 13 | Demonstrate the adequacy of procedures, facilities, equipment, and services for the congregate care of evacuees. |
| Objective 14 | Demonstrate the adequacy of personnel, procedures, equipment, and vehicles for transporting contaminated and/or injured individuals, and the adequacy of medical personnel and facilities to support the operation. |
| Objective 15 | Demonstrate the ability to implement appropriate measures for containment, recovery, and clean up of the release of a hazardous material. |
| Objective 16 | Demonstrate the ability to document a hazardous materials incident/accident and response. |

| EVALUATORS CHECKLIST | |
|---|-----------------|
| Name: | Area Evaluated: |
| In the questions below, comment on what you saw (positively in all cases). Explain what went well, lessons learned, and lessons that must be learned. Please feel free to comment on any agency, team, or inter-agency perspective. | |
| 1. Did all agencies/participants conduct themselves in a safe, prudent manner? | |
| 2. Did you see any information that was communicated but was not acted upon? | |
| 3. Did you see anything that was not communicated but should have been? | |
| 4. Did you see anything that disturbed you regarding the response? | |
| 5. Did you see any resources that appeared to be over-utilized/over-burdened? | |
| 6. Did you see any resources/agencies that appeared to be under-utilized/under-burdened? | |
| 7. How did the interagency interaction and cooperation appear? | |
| 8. Below are the objectives of the LEPC exercise. Rate the agencies and their responders on how well they met their objectives. Please keep in mind that not all agencies have responsibilities for each objective. | |

| |
|---|
| <p>Goal - To exercise the <i>LaGrange County Hazardous Materials Emergency Response Plan</i> for fixed sites, as required by Federal Law, utilizing ALL emergency response agencies, both public and private, in cooperation with private business and industry, in a safe and efficient manner.</p> |
| <p>Objective 1: To demonstrate and evaluate the command and control procedures for a hazardous materials incident of ALL agencies involved by use of the integrated Incident Command System (ICS).</p> |
| <p>Objective 2: To demonstrate and evaluate the LaGrange County Communications System and how ALL agencies will integrate into this system.</p> |
| <p>Objective 3: To demonstrate and evaluate the safety procedures of ALL emergency response agencies.</p> |
| <p>Objective 4: To demonstrate and evaluate the activation and operation of the County EOC.</p> |
| <p>Objective 5: To demonstrate and evaluate the interface between the emergency response agencies and private business and industry.</p> |

APPENDIX 12 - PUBLIC ADDRESS ANNOUNCEMENT SAMPLES

SAMPLE MEDIA RELEASE A: Alert - No Protective Action

The LaGrange County Office of Emergency Management received a report that _____ has occurred. It has been determined that no protective actions are required to ensure and maintain public health and safety.

The LaGrange County Emergency Management Agency will continuously monitor and assess the situation to confirm earlier reports. As monitoring results become available, protective actions may be recommended as needed.

NOTE TO CORRESPONDENTS: _____
_____.

This message has been issued by authority of the LaGrange County Commissioners.
Additional information may be obtained from _____
_____.

Date/Time of Issue: _____
Issued by: _____

The LaGrange County Commissioners have declared an emergency situation in the vicinity of _____. This is a warning to all residents within a _____ mile radius of the _____.

You are advised to seek shelter immediately; go indoors; close windows and doors; and turn off air conditioners, heating systems, and fans. Stay inside until you receive further instructions. There has been a release of hazardous materials.

To avoid exposure, seek shelter indoors immediately; close windows and doors; and turn off air conditioners, heating systems, and fans. Evacuation has not been recommended at this time. Keep your radio and television set turned on for additional information.

NOTE TO CORRESPONDENTS: _____
_____.

This message has been issued by authority of the LaGrange County Commissioners.
Additional information may be obtained from _____
_____.

Date/Time of Issue: _____
Issued by: _____

The LaGrange County Commissioners have declared an emergency situation in the vicinity of _____. Should the decision be made to evacuate your area, you should plan to be away from your home for _____ minutes/hours or less. You should now begin thinking about where you would stay and the necessities you may need to take with you.

You should review any evacuation instructions on hand which may have previously been supplied by local officials. This station will broadcast instructions if an evacuation is ordered. The following items are recommended as evacuation supplies:

1. Two (2) blankets per person or a sleeping bag.
2. Change of clothing.
3. Important papers (checkbook, etc.)
4. Medicine particularly prescription medication.
5. Toiletry articles.

We repeat that evacuation has not yet been recommended. These are only preparatory instructions.

NOTE TO CORRESPONDENTS: _____
_____.

This message has been issued by authority of the LaGrange County Commissioners.
Additional information may be obtained from _____
_____.

Date/Time of Issue: _____
Issued by: _____

The LaGrange County Commissioners have issued an order directing the immediate evacuation of _____.

Local emergency management authorities have begun the evacuation of this area. This evacuation order was issued in response to the reported release of hazardous materials by _____.

Persons living in the affected area should follow the instructions given below.

1. Take the following items with you:
 - a. Two (2) blankets per person or a sleeping bag.
 - b. Change of clothing.
 - c. Important papers (checkbook, etc.)
 - d. Medicine particularly prescription medication.
 - e. Toiletry articles.
2. Lock your home.
3. Goto _____.
Follow the evacuation route nearest you. Do not move against traffic.
4. Time is important, but move safely.
5. Persons not having transportation should notify the _____.
6. People immediately outside of the affected area are not subject to a direct hazard; however, these people should remain alert to any possible changes in instructions resulting from changes in wind direction or accident conditions. Stay by your radio or television. People outside the affected area are also asked not to travel on or near routes being used for evacuation. These routes are: _____.

NOTE TO CORRESPONDENTS: _____.

This message has been issued by authority of the LaGrange County Commissioners.
Additional information may be obtained from _____.

Date/Time of Issue: _____

Issued by: _____

During the period of evacuation, law enforcement officers will patrol the evacuated areas to protect homes and businesses. No unauthorized persons will be allowed in the evacuated areas.

County officials will monitor the affected areas continuously. When conditions are determined safe, you will be notified to return home. Transportation will again be provided for those in need.

NOTE TO CORRESPONDENTS: _____

_____.

This message has been issued by authority of the LaGrange County Commissioners.
Additional information may be obtained from _____
_____.

Date/Time of Issue: _____

Issued by: _____

The LaGrange County Commissioners have announced that the emergency conditions at _____
have ended. It is now safe to return to your residence and/or business.
Repeating, "The emergency conditions in the area of _____ have
now ended. You may return home and resume normal activities. There is no longer any threat to
people in the area."

If you need additional information, you may contact _____
_____.

NOTE TO CORRESPONDENTS: _____
_____.

This message has been issued by authority of the LaGrange County Commissioners.
Additional information may be obtained from _____
_____.

Date/Time of Issue: _____
Issued by: _____

SAMPLE MEDIA RELEASE G: Chemical Release/School Lockdown Notification

The Superintendent of Schools for LaGrange County School Board has issued an information/warning bulletin concerning _____
School. School authorities wish to notify parents that the school will be going to a lockdown due to the _____ incident.

Parents of children attending _____ School(s) are advised to please not attempt picking up their children. Students are safe. We repeat, STUDENTS ARE SAFE. If an evacuation/school closure is required or if students are moved to another location, a media announcement will be made to advise parents when and where the students can be picked up.

If you need additional information, you may contact _____
_____.

NOTE TO CORRESPONDENTS: _____

_____.

This message has been issued by authority of the LaGrange County Commissioners.
Additional information may be obtained from _____
_____.

Date/Time of Issue: _____

Issued by: _____

SAMPLE MEDIA RELEASE H:

School Evacuation

The Superintendent of Schools for LaGrange County School Board has issued an order directing the immediate evacuation of _ School(s). School authorities have begun the evacuation of children to _____

_____.

Parents of children attending _____ School are advised to pick up their children at _____.

If you need additional information, you may contact _____.

NOTE TO CORRESPONDENTS: _____.

This message has been issued by authority of the LaGrange County Commissioners.
Additional information may be obtained from _____.

Date/Time of Issue: _____

Issued by: _____

APPENDIX 13 - LA GRANGE COUNTY LEPC MEMBERSHIP ROSTER (2021)

Chairperson: Terry Martin

Coordinator: Bill Morr

Document Location: 105 N High St, Lagrange, IN 46761

Planning Coordinator: Bill Morr

Community Emergency Coordinator: Bill Morr

Telephone Numbers:

24-hour Emergency: 911 /260-463-1176

Administrative Number: 260-463-1176

| # | Name | Category | Phone | Email | Position | Contact Type |
|----|-------------------|----------------------------|--------------|--|-----------|--------------|
| 1 | Bender , Stewart | Fire Departments | 260-350-2323 | sbender@lagrangesd.com | | Primary |
| 2 | Coney , Bruce | Emergency Medical Services | | bruce.coney@parkview.com | | Primary |
| 3 | Connelly , Bill | Broadcast/Print Media | | publisher@lagrangepublishing.c om | Secretary | Primary |
| 4 | David , Billows | Community Groups | 502-494-8199 | d.billows51@gmail.com | | Primary |
| 5 | Bill Morr | Emergency Management | 260-463-1176 | wmorr@lagrangecounty.org | | Primary |
| 6 | Engleking , Steve | Environmental | | sengleking@purdue.edu | | Primary |
| 7 | Harker , Tracy | Law Enforcement | | tharker@lagrangesd.com | | Primary |
| 8 | Hoover , Jeremy | Hospitals | | jhoover@parkview.com | | Primary |
| 9 | Martin , Terry | Local/State Government | | tmartin@lagrangecounty.org | Chair | Primary |
| 10 | Gingerich, Harold | Local/State Government | | hgingerich@lagrangecounty.org | | Primary |
| 11 | Milliman , Alicia | Health | 260-336-5096 | amilliman@lagrangecounty.org | | Primary |
| 12 | Oberlin, Amy | Broadcast/Print Media | | Amyoberlin7@gmail.com | | Primary |
| 13 | Parish , Ben | Transportation | 260-336-9110 | bparish@lagrangecounty.org | | Primary |
| 14 | Webster , Mark | Industry | | mtwebster@niscoseals.com | | Proxy |
| 15 | | | | | | |

ROSTER SUBMITTAL DATE: 2020

mail to: Ian Ewusi-Wilson, Indiana Emergency Response Commission
302 W Washington, Indiana Gov. Ctr. South, Room E-208, Indianapolis, IN
46204 Fax: 317-233-5006

APPENDIX 14 - COUNTY/CITY/TOWNSHIP CONTACT NUMBERS

| CONTACT | PHONE NUMBER WITH AREA CODE 260 |
|------------------------------------|------------------------------------|
| Auditor | 499-6311 |
| Ambulance Service | 463-2143 |
| Animal Hospital | 463-2157 |
| County Offices/Courthouse | 499-6300/4311 |
| County Commissioners | 499-6314 |
| Dispatch Center | 463-7491 |
| County Engineer | 499-6352 |
| Emergency Management | 350-2323 (C) |
| Environmental Health | 499-4182 |
| GIS Mapping | 499-6313 |
| Highway Dept | 499-6353 |
| Board of Health (Co. Health Nurse) | 499-4182 |
| Parkview-LaGrange Hospital | 463-9000 |
| Prosecuting Attorney | 499-6326 |
| Sheriff | 463-7491 |
| Treasurer | 499-6316 |

| LOCALITY | PHONE NUMBER WITH AREA CODE 260 |
|-------------------------|------------------------------------|
| Town of LaGrange | 463-3241 |
| Town of Shipshewana | 768-4743 |
| Town of Topeka | 593-2300 |
| Town of Wolcottville | 854-3151 |
| Bloomfield Twp Trustee | 463-3411 |
| Clay Twp Trustee | 463-2750 |
| Clearspring Twp Trustee | 463-5212 |
| Eden Twp Trustee | 593-2045 |
| Greenfield Twp Trustee | 463-6511 |
| Johnson Twp Trustee | 854-2160 |
| Lima Twp Trustee | 562-2042 |
| Milford Twp Trustee | 351-9103 |
| Newbury Twp Trustee | 768-7330 |
| Springfield Twp Trustee | 367-2124 |
| VanBuren Twp Trustee | 768-3098 |

APPENDIX 15 - CHEMICAL EMERGENCY NOTIFICATION REPORT

IMMEDIATE NOTIFICATION

In the event of a release of hazardous materials, wastes, or substances, an immediate notification must be made in the following order as required by the type of material, the quantity released, and/or the area affected.

Local Response Agency

1. Notify 911 (for injury, fire, and/or public health or safety issue)
2. Notify the LaGrange County LEPC, (Name/phone _____). When hazardous materials are released in quantities reportable under State, Federal, or local regulations, the code official shall be notified.
3. Notify the Indiana Emergency Response Commission (phone _____). If the quantity released exceeds the Threshold Planning Quantity (TPQ) or Reportable Quantity (RQ) and has or will get off the property, in the air, land, or water. Notification must be made within fifteen (15) minutes of discovery that the release exceeds the reporting quantity.
4. Notify Federal agencies, as appropriate.

REQUIRED NOTIFICATION

The following information will be required for the Federal, State, and local Notifications:

Local notification

Notify the LaGrange County Local Emergency Planning Committee at _____.

Notice shall include the following information (to the extent known at the time of the notice, and so long as there no delay in responding to the emergency results):

1. Name and phone number or radio call number.
2. Location and type of accident.
3. The chemical name or identity of the substance involved in the release.
4. An indication of whether the substance is regulated by an agency of the government.
5. An estimate of the quantity of any such substance that was released into the environment.
6. The time and duration of the release.
7. The medium or media into which the release occurred.
8. Any known or anticipated acute or chronic health risks associated with the emergency and, where appropriate, advice regarding medical attention necessary for exposed individual.

State Notification (Indiana Department of Environmental Management)

In the event the one (1) kilogram of hazardous waste; one hundred (100) kilograms of a substance that by virtue of being released becomes a hazardous waste; or any quantity of a material that poses a potential threat to human health or the environment, notification must be made to the Indiana Department of Environmental Management (phone number _____)

As part of the notification, the FEC must provide the following information:

1. Name, phone number, and address of the person responsible for the spill
2. Name, title, and phone number of individual reporting the spill
3. Time and date of spill

4. Location of spill
5. Description contained on the manifest and the amount of material spilled
6. Cause of spill
7. Emergency action taken to minimize the threat to human health and the environment

Within 15 days of the spill of hazardous wastes or materials, the CEC will submit a written report to the Indiana Department of Environmental Management including the following information:

1. The person's name, address; and telephone number
2. Date, time, location, and nature of incident
3. Name and quantity of material(s) involved
4. The extent of injuries, if any
5. An assessment of actual or potential hazards to human health or the environment
6. The estimated quantity and disposition of recovered material that resulted from the incident

Federal Notification (40CFR 302.6, 40 CFR 355)

National Response Center (NRC) (800-424-8802) is to be notified if the quantity exceeds the published Reportable Quantity (RQ). See 40 CFR 302.4 or 49 CFR 172.101 Appendix A. Provide the following information to the NRC:

1. Name and telephone number of the reporter
2. Name and address of the facility
3. Time and type of incident
4. Name and quantity of material(s) involved
5. The extent of injuries, if any
6. Possible hazards to human health and environment outside the facility

The CEC must note in the operating record the time, date, and details of any incident that requires implementation of their response plan.

Within 15 days after the incident, the CEC must submit a written report on the incident to the Regional Administrator. The report must include:

1. Name, address, and telephone number of the owner or operator
2. Name, address, and telephone number of the facility
3. Date, time, and type of incident
4. Name and quantity of material(s) involved
5. The extent of injuries, if any
6. An assessment of actual or potential hazards to human health or the environment
7. Estimated quantity and disposition of recovered material that resulted from the incident

Department of Transportation (49 CFR 171.15; 171.16)

In the event of a release of hazardous materials in transit (including loading, unloading, or temporary storage) resulting in a fatality or hospitalization; \$50,000 damage or more; evacuation of the general public lasting more than one hour; one or more transportation route closed or shutdown for more than one hour; or the operational flight plan or routine of an aircraft is altered; fire, breakage, spillage, or suspected contamination involving and etiologic material or;

any condition deemed worthy of reporting by the carrier, then, immediate telephonic notification through the National Response Center and follow up written reporting shall take place.

SECTION 304 REPORTING FORM
THIS FORM PROVIDES GUIDANCE FOR INITIAL NOTIFICATION
EMERGENCY PLANNING AND COMMUNITY RIGHT-TO-KNOW ACT

National Response Center # 1-800-424-8802

State Warning Point (SWP) # _____

Incident occurred Date/Time: _____ / _____

Caller: _____ Callback Phone # _____

Time of Call _____

Caller Represents (Name Company or County) _____

Comments (Incident Description) _____

Emergency Assistance Requested: Yes / No Type Assistance Needed: _____

On Scene Contact: _____ On Scene Phone # _____

Facility Name: _____

Facility Address: _____ Facility City: _____

Number Injured: _____ # of Fatalities _____ # Missing: _____ # Evacuated/ Sheltered

Damage: _____

Hazardous Materials Details _____

Responsible Party: _____ Responsible Party Phone # _____

Responsible Party Address: _____

Materials Involved: (Circle appropriate one - Gas/Liquid/Solid) - CAS Number _____

Name Medium: Air _____ Water _____ Land _____

Section 304? Yes/No CERCLA Substance Yes/No

Container: Container Size: _____

Other: _____

Amount Released: _____ Rate of Release _____

Cause of Release: _____

Time Release Began: _____ Time Discovered: _____ Time Release Ended: _____

Reason for late report if more than 15 minutes elapsed from discovery to report: _____

Weather: Temperature _____ Wind Direction/Speed: _____ Rain: Yes/ No

Potential Health Risk: _____

Area(s) Involved: _____

Other: _____

Message Received by: _____ Name: _____ Time/Date: _____

YOU MUST SUBMIT A WRITTEN FOLLOW-UP REPORT ON COMPANY LETTERHEAD WITHIN
14 DAYS TO THE SERC WITH COPY TO THE LOCAL LEPC.

APPENDIX I6 - RESOURCE LIST FROM COUNTY EMERGENCY RESPONSE TEAMS

| DEPARTMENT | EQUIPMENT |
|---|---------------------------------|
| Kendallville Fire Department Hazmat Team* (Noble County) / Angola (Steuben) | Level A Chemical Suits |
| | Mobile Air Compressor (Cascade) |
| | Mobile Command Unit |
| | A-B-C Chlorine Kits |
| | Dome Clamps |
| | Non-Sparking Tools |
| | Diaphragm Pumps – Air Operated |
| | 60 Minute SCBA |
| | Air Monitoring Eq. |
| | Chemical ID Eq. |
| | MASS DECON UNIT |
| Howe Fire Dept. | Minor Absorbents |
| Johnson Twp Fire Dept. | Minor Absorbents |
| LaGrange Fire Dept. | Minor Absorbents |
| Mongo VFD | Minor Absorbents |
| Shipshewana Fire Dept. | Minor Absorbents |
| Stroh VFD | Minor Absorbents |
| Topeka Fire Dept. | Minor Absorbents |

* (Noble County's Hazmat Team responds under mutual aid when called for assistance).

APPENDIX 17 - HAZARDOUS MATERIAL DECISION EVENT TREES

LaGrange County Emergency Event Tree

Chemical Spill

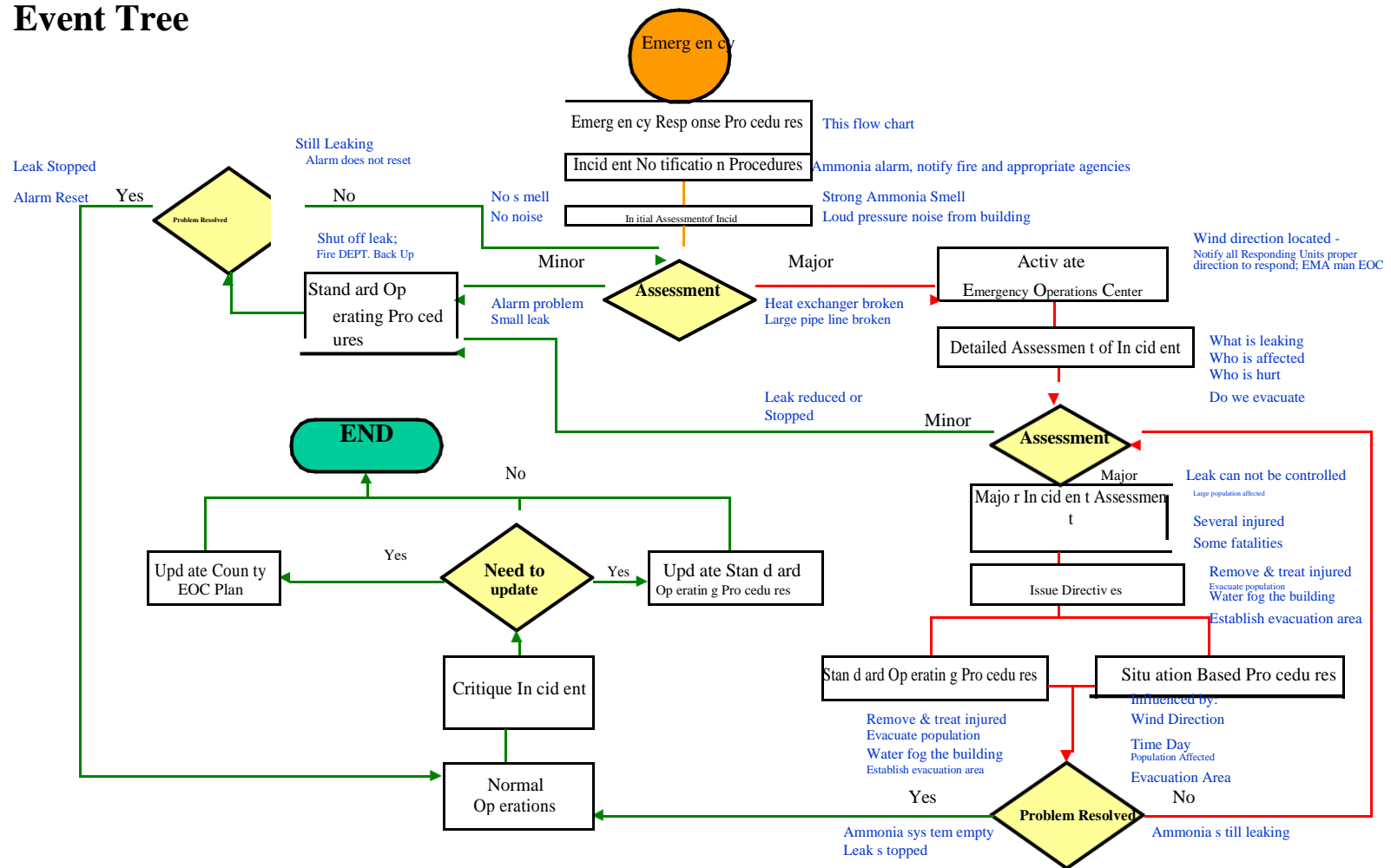

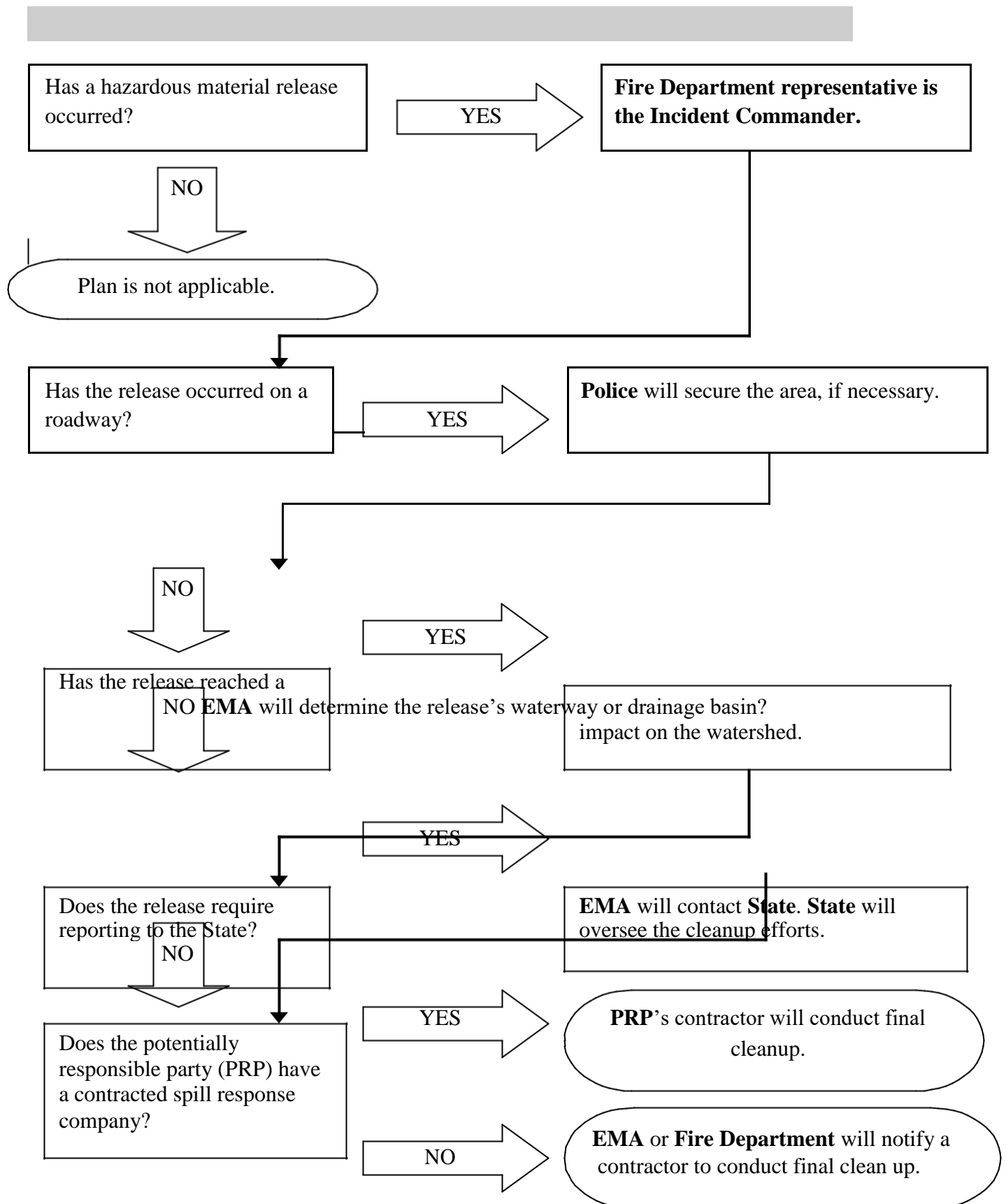

I. Purpose

Hazard materials incidents often require some type of evacuation. The purpose of this procedure is to set a guideline for evacuation of occupants within an area that is deemed unsafe by responders.

II. Procedure

A. Recognition

Once a hazardous materials emergency is recognized by the public or at a facility. Responders are requested via 911 emergency dispatch.

B. Analysis

Responders and Facilities officials will analyze the situation and use the ERG to determine the amount of evacuation that is required.

C. Isolate

Responders should isolate the area to prevent unneeded entry into a contaminated area. Isolation could include barrier tape and/or personnel at points of entry.

D. Notification

Notification to all those who need to be evacuated would be completed once the analysis of the situation has been completed.

III. Evacuation resources

Depending on the amount to be evacuated and the overall area to be evacuated, numerous personnel may be required to complete the task.

IV. Type of evacuations

A. Spontaneous Evacuation: Residents or citizens in the threatened areas observe an emergency event or receive unofficial word of an actual or perceived threat and, without receiving instructions to do so, elect to evacuate the area. Their movement, means, and direction of travel are unorganized and unsupervised.

B. Voluntary Evacuation: This is a warning to persons within a designated area that a threat to life and property exists or is likely to exist in the immediate future. Individuals issued this type of warning or order are NOT required to evacuate; however, it would be to their advantage to do so.

C. Mandatory or Directed Evacuation: This is a warning to persons within the designated area that an imminent threat to life and property exists and individuals

V. Transportation of evacuees

A. Depending on the number of evacuees, the following actions will take place:

1. Self evacuate evacuees use personal vehicles to transport their families to safe area.
2. Transportation of evacuees: large number of evacuees or the incident does not allow for self-evacuation.

B. Transportation assistance can be requested through the Emergency Manager or ESF-1 within the Emergency Operations Center.